



## Series Names & Model#’s

Standard Expanded Metal - w/o Back	— 166-1028
Standard Expanded Metal w/Back	— 166-1046
Expanded Metal Player’s Bench w/o Back	— 166-1037
Personalized Expanded Metal Bench	— 166-1148
Standard Perforated Metal - w/o Back	— 166-1194
Standard Perforated Metal w/Back	— 166-1199
Perforated metal Player’s Bench w/Back	— 166-1204
Personalized Perforated Metal Bench	— 166-1162

## Product maintenance

Inspect all hardware and fasteners, regularly check that all nuts and bolts are secure. Periodically examine for any signs of vandalism on any of your products thermoplastic surfaces. If any thermoplastic surface is vandalized by spray paint, simple take a rag and a aerosol can of WD40® and wipe the spray paint off. If the thermoplastic surface has any cuts simple take an industrial heat gun to the affected area. For regular cleaning use soap and water.

## Thermoplastic Coating

The outdoor furniture is covered in a copolymer-based thermoplastic powder coating. Thermoplastic is environmentally safe, the coating will never fade, crack, peel, warp, or discolor for the life of the product. Thermoplastic has the best adhesion rate of any other process. This keeps the metal base free of any corrosion possibilities. Thermoplastic is applied at a thickness of 25-30 mills. This allows maximum protection with the best possible surface. Thermoplastic can be easily repaired. Cuts are repaired by heating the affected area with an industrial heat gun. The thermoplastic will rebound itself. The properties of thermoplastic also make spray painting difficult for vandals. Simply wash product with a standard industrial cleaner.

## Specifications

### General

All seats and backs of the listed products above are protected with Thermoplastic coating. Black powder coated galvanized steel legs and support structure. Available in expanded metal and perforated metals seats and backs. Personalization is also available.

Weight will vary base on chosen style as well as length.

4’ bench w/Back - Weight: 134-155 lbs.  
6’ bench w/Back - Weight: 140-160 lbs.  
8’ bench w/Back - Weight: 170-190 lbs.  
10’ bench w/Back - Weight: 218-238 lbs.  
15’ bench w/Back - Weight: 308-338 lbs.

4’ bench w/o Back - Weight: 70 lbs.  
6’ bench w/o Back - Weight: 76-81 lbs.  
8’ bench w/o Back - Weight: 94-98 lbs.  
10’ bench w/o Back - Weight: 101 lbs.  
15’ bench w/o Back - Weight: 170 lbs.

# Standard Metal Bench with Back

Top view

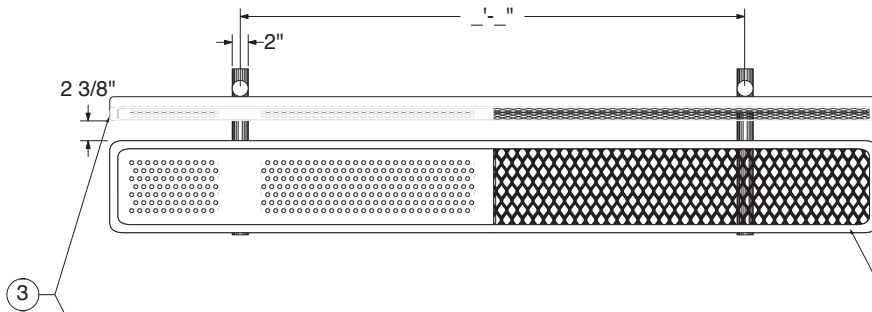

Front View

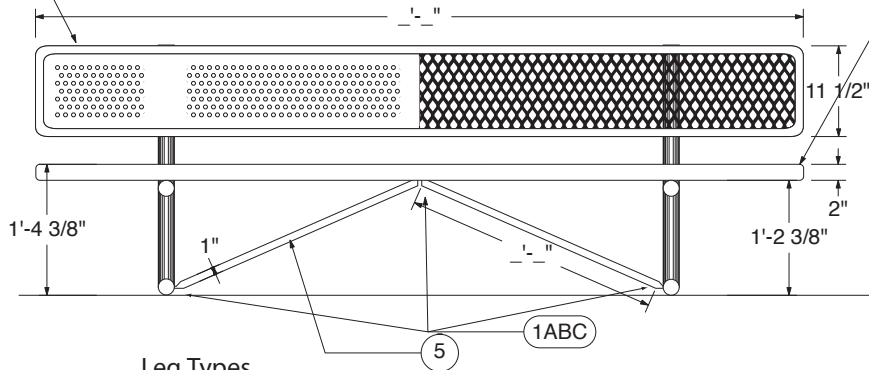

Leg Types

Leg Side view

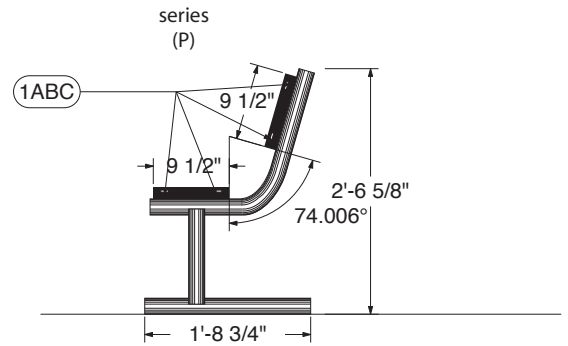

Side view

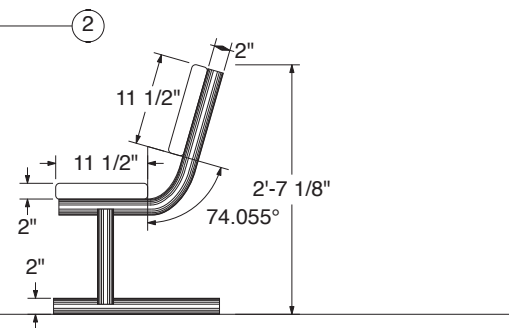

Front View

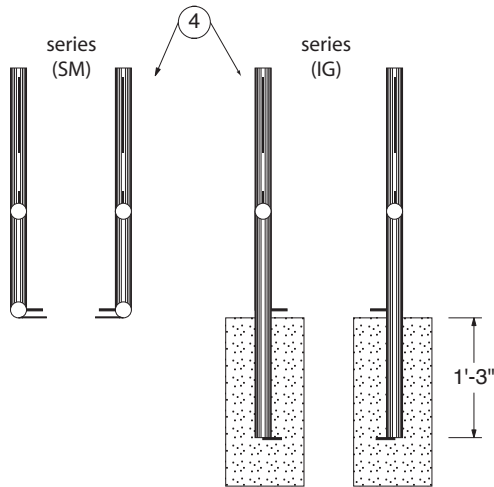

Top view

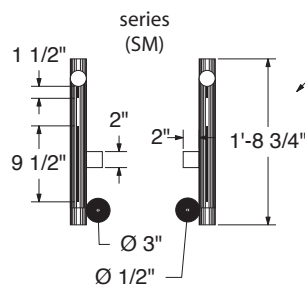

Side view

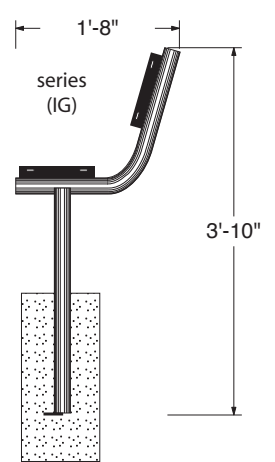

## Available Styles



Expanded Metal



Perforated Metal

## Quantities (per bench)

1A - 5/16" Hex head bolts	- qty 11
1B - 5/16" Washer	- qty 22
1C - 5/16" Nut	- qty 11
2 - Bench seat	- qty 1
3 - Bench back	- qty 1
4 - Leg Types (per bench)	- qty 2
5 - Cross braces	- qty 2

## Hardware

Ⓐ 5/16" Hex head bolt

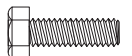

Ⓑ 5/16" Washer



Ⓒ 5/16" Nut



scale 1/2" = 1'

3350 NW Boca Raton Blvd., Suite B2 Boca Raton, FL, 33431

Phone: 561.620.7878 Fax: 561.620.8668

# Standard Metal Bench w/o Back

Top view

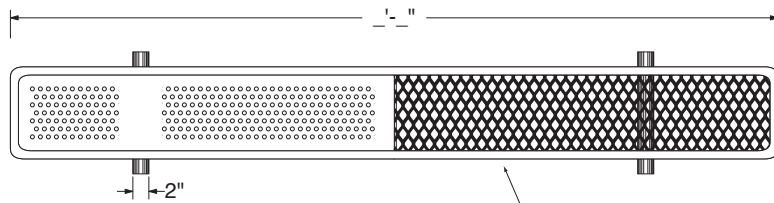

Seat Side view

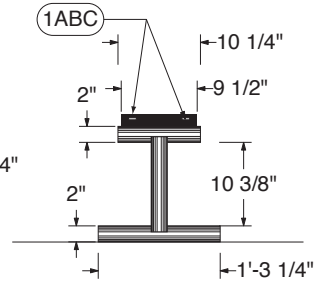

Front View

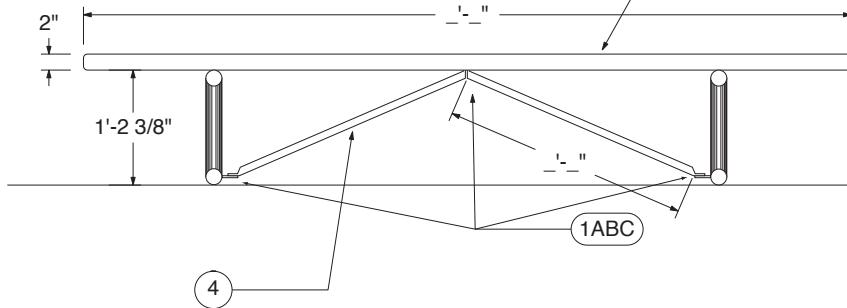

Side view

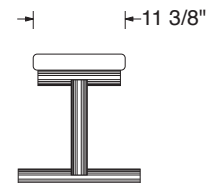

Front View

Top view

Side view

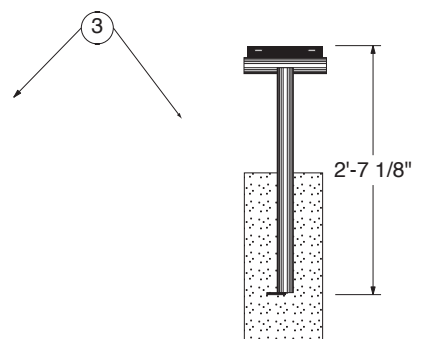
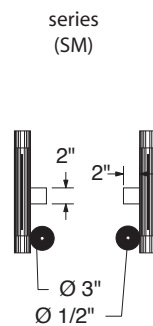
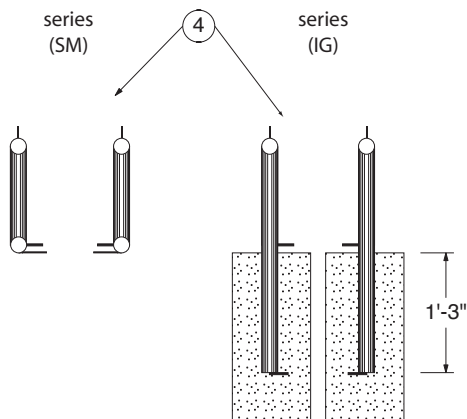

## Available Styles

## Quantities (per bench)

## Hardware



Expanded Metal

Perforated Metal

1A - 5/16" Hex head bolts	- qty 7
1B - 5/16" Washer	- qty 14
1C - 5/16" Nut	- qty 7
2 - Bench seat	- qty 1
3 - Leg Types (per bench)	- qty 2
4 - Cross Braces	- qty 2

Ⓐ 5/16" Hex head bolt

Ⓑ 5/16" Washer

Ⓒ 5/16" Nut

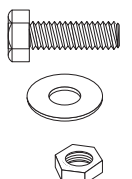

scale 1/2" = 1'

3350 NW Boca Raton Blvd., Suite B2 Boca Raton, FL, 33431

Phone: 561.620.7878 Fax: 561.620.8668

# Assembly Instructions

Standard Expanded Metal - w/o Back	—	166-1028
Standard Expanded Metal w/Back	—	166-1046
Expanded metal Player's Bench w/o Back	—	166-1037
Personalized Expanded Metal Bench	—	166-1148
Standard Perforated Metal - w/o Back	—	166-1194
Standard Perforated Metal w/Back	—	166-1199
Perforated metal Player's Bench w/Back	—	166-1204
Personalized Perforated Metal Bench	—	166-1162

Note: Work 1 one side at a time.

Do not tightly secure bolts until product is fully assembled.

## Step 1:

Check that all hardware, legs, and seats are accounted for. Total parts for the assembly of one bench with back two legs(SM or IG or P), two seats, two brace rod, eleven 5 /16" Hex Head Bolts, nuts, and twenty two washers.

Total parts for the assembly of one bench with out back two legs(SM or IG or P), one seat, two brace rod, seven 5 /16" Hex Head Bolts, nuts, and fourteen washers.

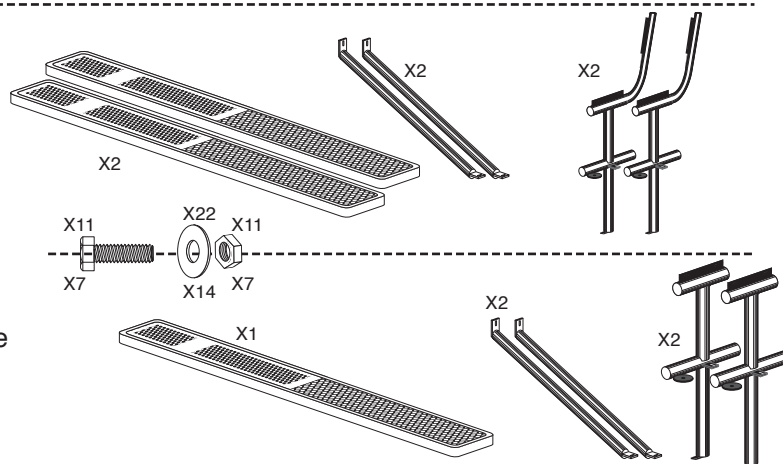

## Step 2A:

Assembly of all benches with backs are the same. Take one of the legs and stand it up right, then take the seat and rest it on the the leg (make sure that the leg is on the outside of the bench attachment.) With out tightening any of the bolts, continue onto the other leg and attach the bolts at the top of the leg. Now lay down the bench on its back. Now grab the back and lay it on the legs, then attach the bolts. Put the bench back up right and then attach the two leg braces, start with one side by attaching the bolt at the bace of the leg then for the first leg slide the bolt thought the hole where the brace meats teh seat. Now take the second brace and attach the bolt to the leg and to the bolt that is holding the first brace.

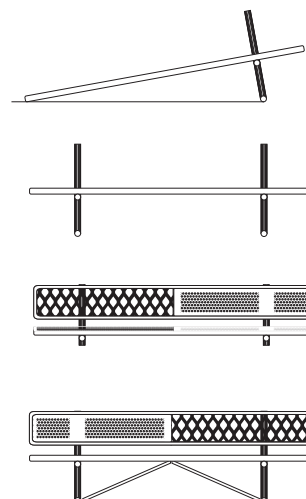

*(To prevent damage to your bench  
place a blanket underneath the bench.)*

# Assembly Instructions

---

Standard Expanded Metal - w/o Back	—	166-1028
Standard Expanded Metal w/Back	—	166-1046
Expanded Metal Player's Bench w/o Back	—	166-1037
Personalized Expanded Metal Bench	—	166-1148
Standard Perforated Metal - w/o Back	—	166-1194
Standard Perforated Metal w/Back	—	166-1199
Perforated metal Player's Bench w/Back	—	166-1204
Personalized Perforated Metal Bench	—	166-1162

## Assembly continuation

---

### Step 2B:

Assembly of all benches with out backs are the same. Take the seat and flip it over then take one of the leg (make sure that the leg is on the outside of the bench attachment) and attach it to the seat. With out tightening any of the bolts, continue onto the other leg and attach the bolts at the top of the leg. Put the bench back up right and then attach the two leg braces, start with one side by attaching the bolt at the bace of the leg then for the first leg slide the bolt thought the hole where the brace meets teh seat. Now take the second brace and attach the bolt to the leg and to the bolt that is holding the first brace.

*(To prevent damage to your bench  
place a blanket underneath the bench.)*

---

### Step 3:

After all bolts are in place flip bench on its feet. Then make sure the bench is level before tightening all of the bolts in the same progression that you started with. After all bolts are tightened enjoy your new bench.

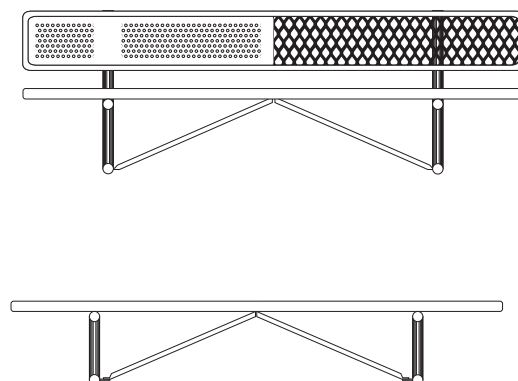
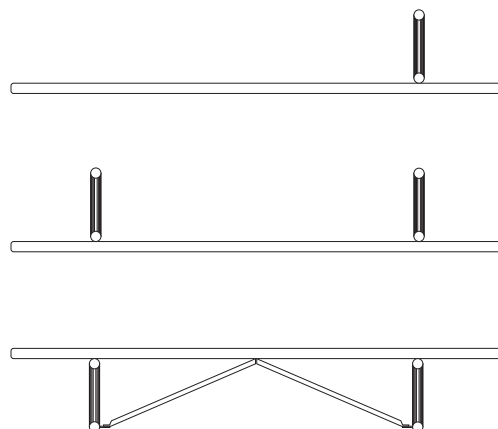

## Cross brace sizes

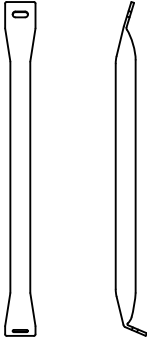

4' BENCH 22"

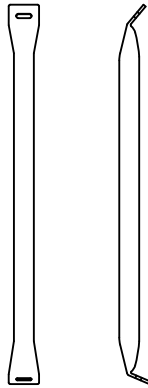

6' BENCH 25"

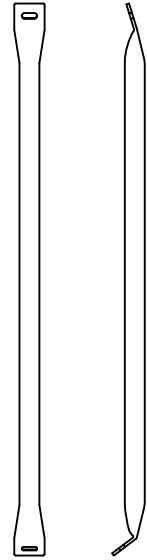

8' BENCH 36  $\frac{3}{8}$ "

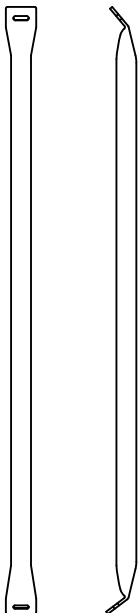

10' BENCH 40"

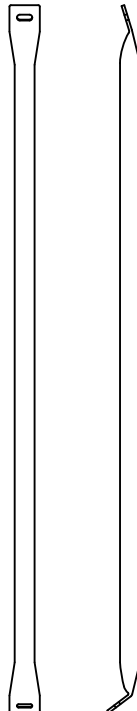

15' BENCH 47"

# Standard Bench with Back

Item 166-1148

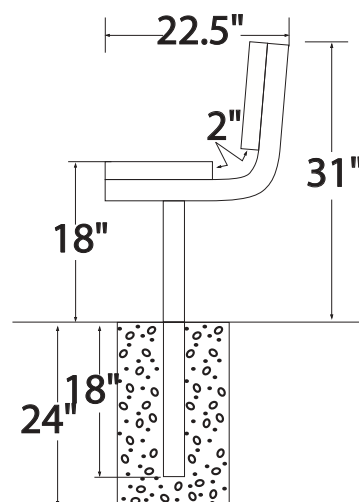
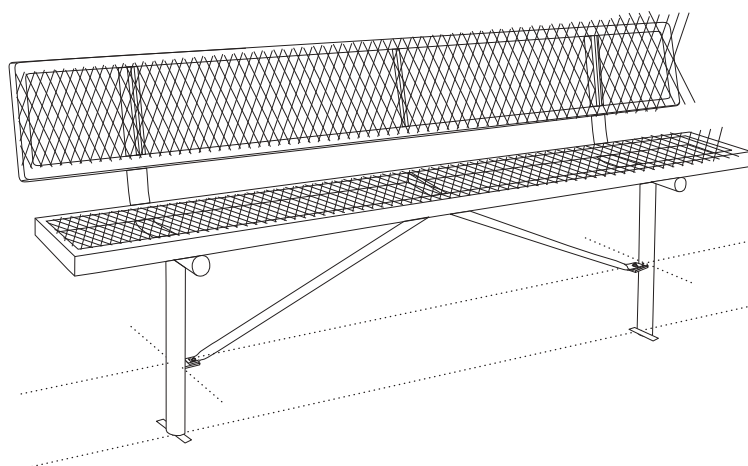
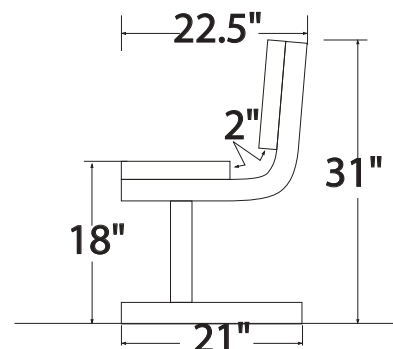
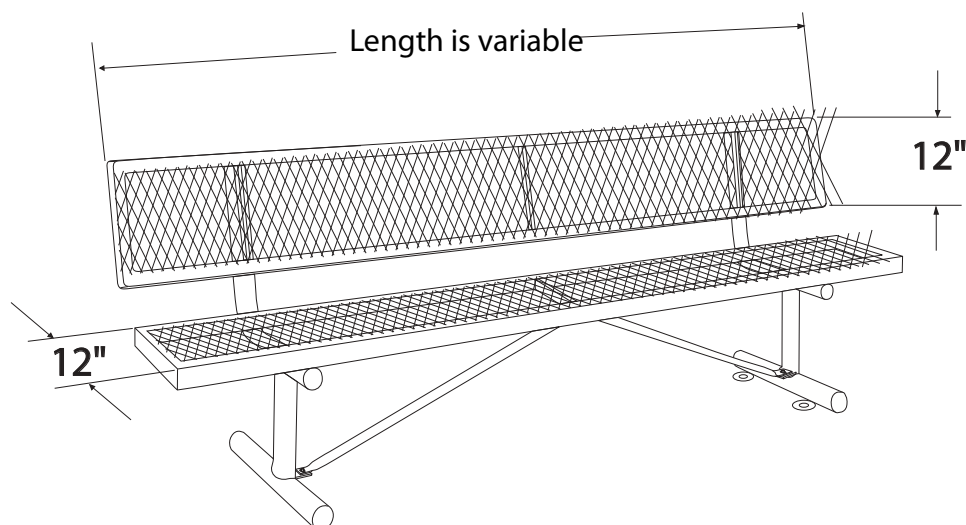

## Benches with Backs, 4', 6', 8', 10"

- Personalization available.
- Expanded metal seats & backs.
- Available in perforated metal.
- Thermoplastic coated.
- Black powder coated galvanized steel understructure.
- Variety of lengths.



3350 NW Boca Raton Blvd., Suite B2 Boca Raton, FL, 33431

Phone: 561.620.7878 Fax: 561.620.8668



## Thermoplastic — the Smart Choice.

Our 166- series thermoplastic outdoor furniture is covered in a copolymer-based thermoplastic coating that is UV-stabilized and is highly resistant to both hard wear and severe weather. Thermoplastic is environmentally safe. The coating will not fade, crack, peel, warp, or discolor for the life of the product. Thermoplastic can be easily repaired. Cuts are repaired by heating the affected area with an industrial heat gun. The thermoplastic will rebound itself. The properties of thermoplastic also make spray painting pointless for vandals. Simply wash the product with a standard industrial cleaner. The tables, benches, receptacles, and accessories are available in several different thermoplastic-coated metal patterns:



**Perforated Metal**



**Expanded Metal**



**Wire**



**Ribbon**



**Rod**



**Diamond Pattern**

### Thermoplastic Is Graffiti Proof!

1. If spray paint is applied to the thermoplastic coating, it is very easy to remove using a common aerosol.
2. Simply spray WD-40™ on the offending graffiti.
3. Watch as the dried paint is quickly eliminated from the thermoplastic surface.
4. It's simple and SAFE!



### 166 series Thermoplastic color choices:

Black		Red	
Orange		Yellow	
Green		Black Green	
Blue		Navy	
Purple		Burgundy	
Brown		Beige	
Gray		Granite	
Sandstone			





## Series Name s & Model#’s

Standard Expanded Metal - w/o Back	—	166-1028
Standard Expanded Metal w/Back	—	166-1046
Expanded Metal Player’s Bench w/oBack	—	166-1037
Personalized Expanded Metal Bench	—	166-1148
Standard Perforated Metal - w/o Back	—	166-1194
Standard Perforated Metal w/Back	—	166-1199
Perforated metal Player’s Bench w/o Back	—	166-1204
Personalized Perforated Metal Bench	—	166-1162

## Product maintenance

Inspect all hardware and fasteners, regularly check that all nuts and bolts are secure. Periodically examine for any signs of vandalism on any of your products thermoplastic surfaces. If any thermoplastic surface is vandalized by spray paint, simply take a rag and a aerosol can of WD40® and wipe the spray paint off. If the thermoplastic surface has any cuts simply take an industrial heat gun to the affected area. For regular cleaning use soap and water.

## Thermoplastic Coating

The outdoor furniture is covered in a copolymer-based thermoplastic powder coating. Thermoplastic is environmentally safe, the coating will never fade, crack, peel, warp, or discolor for the life of the product. Thermoplastic has the best adhesion rate of any other process. This keeps the metal base free of any corrosion possibilities. Thermoplastic is applied at a thickness of 25-30 mills. This allows maximum protection with the best possible surface. Thermoplastic can be easily repaired. Cuts are repaired by heating the affected area with an industrial heat gun. The thermoplastic will rebound itself. The properties of thermoplastic also make spray painting difficult for vandals. Simply wash product with a standard industrial cleaner.

## Specifications

### General

All seats and backs of the listed products above are protected with Thermoplastic coating. Black powder coated galvanized steel legs and support structure. Available in expanded metal and perforated metals seats and backs. Personalization is also available.

Weight will vary base on chosen style as well as length.

4’ bench w/Back - Weight: 134-155 lbs.

6’ bench w/Back - Weight: 140-160 lbs.

8’ bench w/Back - Weight: 170-190 lbs.

10’ bench w/Back - Weight: 218-238 lbs.

15’ bench w/Back - Weight: 308-338 lbs.

4’ bench w/o Back - Weight: 70 lbs.

6’ bench w/o Back - Weight: 76-81 lbs.

8’ bench w/o Back - Weight: 94-98 lbs.

10’ bench w/o Back - Weight: 101 lbs.

15’ bench w/o Back - Weight: 170 lbs.