

347-1115

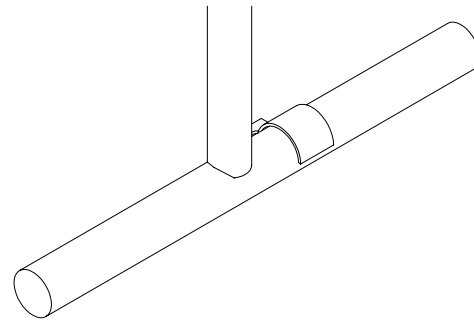

- 
- 1 Position Bench in desired location and mark location of anchor bolts.
  - 2 Drill hole in concrete using a 3/8" masonry bit. The hole should be at least 1-5/8" deep. (see illus. 1)
  - 3 Clean the debris from the hole and check the depth.
  - 4 Assemble the nut and washer. Drive the anchor through the hole in the clamp. (see illus. 2)
  - 5 Tighten the nut 3 to 5 turns to expand the anchor. (see illus. 3)

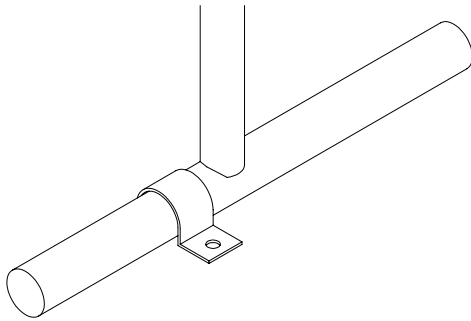

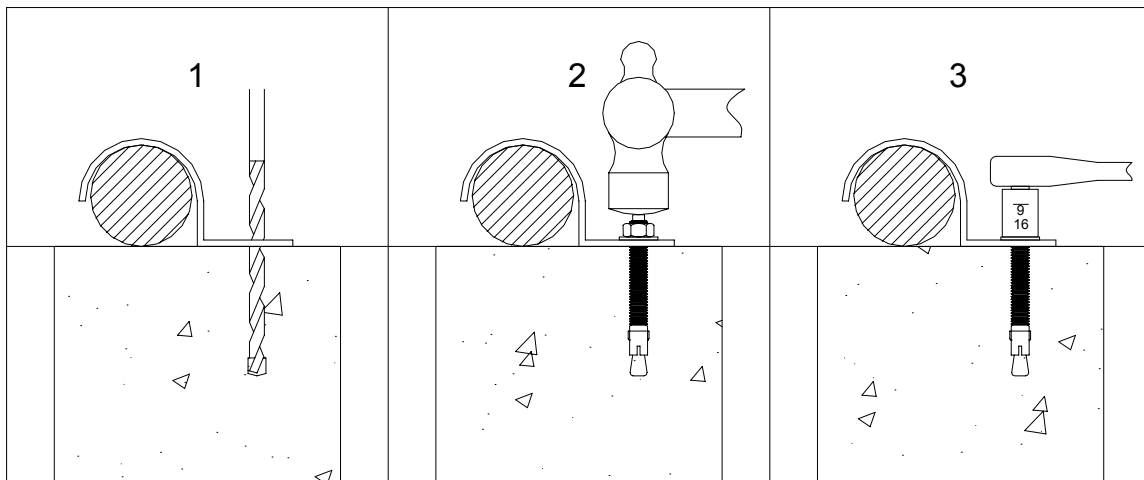

## **347 Series Color Choices**

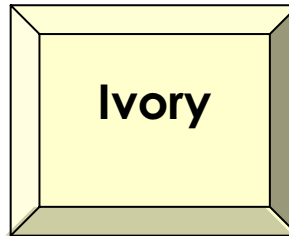
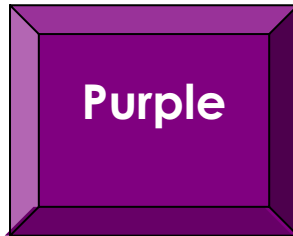
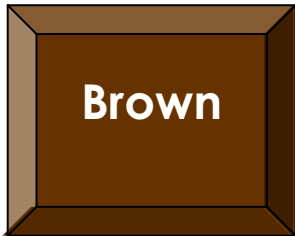
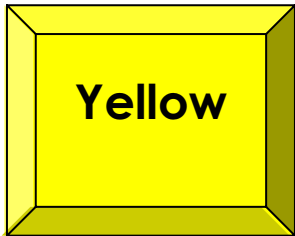
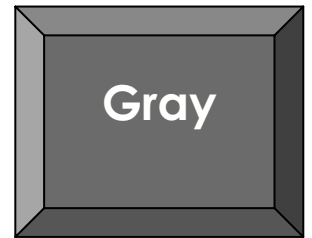
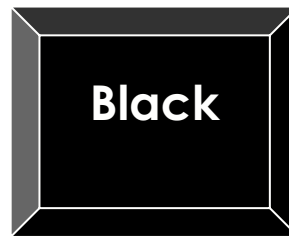
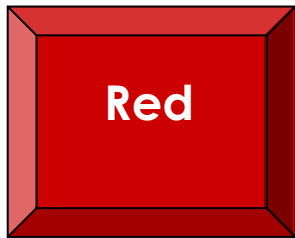
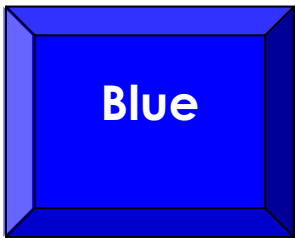

**Colors shown may vary slightly from actual product. Custom colors available**