

**398-7009 LEG PRESS (FOOTING)**  
**398-7009 LEG PRESS (IN GROUND)**  
**398-7009 LEG PRESS (SURFACE)**

| Parts List                   |           |             |           |             |
|------------------------------|-----------|-------------|-----------|-------------|
| DESCRIPTION                  | (FOOTING) | (IN-GROUND) | (SURFACE) | PART NUMBER |
| LEG PRESS                    | 1         | 1           | 1         | 206580      |
| BASE COVER                   | 1         | 1           | 1         | 206699      |
| FOOTBUCK WELD ASS'Y          | 0         | 1           | 0         | 206467      |
| <b>HARDWARE COMPLETE</b>     | 0         | 0           | 1         | 206517      |
| <b>HARDWARE COMPLETE</b>     | 1         | 0           | 0         | 206518      |
| <b>HARDWARE COMPLETE</b>     | 0         | 1           | 0         | 206519      |
| 1/2" ANCHOR ROD              | 0         | 2           | 0         | 135038*     |
| 3/4" x 2" HEX HEAD CAP SCREW | 0         | 4           | 0         | 801533*     |
| 3/4" WEDGE ANCHOR            | 0         | 0           | 4         | 206358*     |
| 3/4" ANCHOR BOLT             | 4         | 0           | 0         | 800001*     |
| 3/4" HEX NUT                 | 8         | 4           | 0         | 804058*     |
| 3/4" FLATWASHER (2" O.D.)    | 8         | 4           | 0         | 817420*     |
| 3/4" LOCKWASHER              | 4         | 4           | 4         | 817354*     |

*Unless Otherwise Specified, All Units of Measure are Each*

*Items listed below Hardware Complete line are included with Hardware Complete Number*

**Warning: During Installation, Hardware And Small Parts Are Choking Hazards For Young Children. Store Unused Parts Appropriately Until Assembly Is Completed. Once Assembly Is Completed, Remove Any Unused Parts From The Play Environment And Dispose/Save Them In A Secure Location. Any bolt end protruding more than two full threads beyond the face of the nut causes risk of clothing entanglement.**

**Promptly cut-off flush, file smooth, and treat to prevent corrosion.**

**Note: Peen Tee-Nuts and Flatwashers to match radius of pipe after assembly is complete.**

**Note: Loctite (supplied by others) should be used on any non-patch hardware.**

**SPECIFICATIONS:**

**BACKREST:** The Backrest shall be constructed from injection molded Nylon W6.

**BASE COVER:** The Base Cover shall be constructed from aluminum and powder coated.

**BOLT CAP:** The Bolt Cap shall be constructed from aluminum and powder coated.

**FOOTREST:** The Footrest shall be constructed from injection molded Nylon W6.

**HANDLE GRIP:** The Handle Grip shall be constructed from injection molded PVC.

**INSTRUCTIONS:** The Instructions shall be constructed from aluminum produced by silk-screen printing.

**MAIN PIPE:** The main frame shall be an all welded assembly fabricated from SPP (carbon steel pipe) and dual phase steel plate. The frame shall be powder coated.

**MODULE CASE:** The Module Case shall be constructed from stainless steel and powder coated.

**POST CAP:** The Post Cap shall be constructed from injection molded Polyethylene.

**SADDLE:** The Saddle shall be constructed from injection molded Nylon W6.

**HARDWARE:** All nuts, bolts, screws, and lock washers used in the assembly shall be stainless steel, yellow dichromate plated steel, blue-coat plated steel, mechanically galvanized or powder coated/yellow dichromate plated steel. All primary fasteners shall be 304 alloy stainless steel. Fasteners with yellow dichromate treatment have an electro-deposited, 99.9% pure zinc substrate applied from a specially formulated solution sealed with a yellow dichromate top coat designed to work in conjunction with the zinc plating.

**398-7009 LEG PRESS (FOOTING)**

**398-7009 LEG PRESS (IN GROUND)**

**398-7009 LEG PRESS (SURFACE)**

**NOTE:** Do not overtighten bolts. To overtighten may cause buckling or dimpling of some parts.

**NOTE:** Read installation instructions thoroughly before starting assembly. Pour concrete only after final assembly is completed. Bracing material is required during assembly.

**NOTE:** Assembly and leveling times will be greatly reduced if a transit is used to set location and depth of ground holes.

**INSTALLATION INSTRUCTIONS FOR (FOOTING):**

1. Attach Chair Pipe Ass'y to Main Post Ass'y using Nut Cap, Nylon Nut, M12 Lock Washer, M12 Washer, M12 Cap Washer, M12 Large Washer, Square Washer, Spacer, and Square Bar and Main Shaft Ass'y. See Chair Pipe Ass'y Detail.
2. Dig holes or drill holes according to Plan View and Elevation View. **NOTE:** Due to extremes in weather and soil conditions, hole size may have to be increased to meet local conditions.
3. Fill hole with concrete. While the concrete is still soft, yet firm enough to support the Leg Press, Place (4) Anchor Bolts of the Leg Press in position. See Footing Detail. **NOTE:** Use Leg Press as a template for Anchor Bolt location, then remove Leg Press.

**IMPORTANT:** DO NOT MOUNT THE LEG PRESS TO THE ANCHOR BOLTS FOR AT LEAST 7 DAYS.

4. After concrete has cured and set for a minimum of 7 Days, attach Leg Press to 3/4" Anchor Bolt using 3/4" Flat Washer (2" O.D.), 3/4" Lock Washer, and 3/4" Hex Nut. See Footing Assembly Detail.
5. Attach Base Cover to Equipment Post using Base Cover Nut and Base Cover Bolt included with Base Cover. See Base Cover Detail.

**INSTALLATION INSTRUCTIONS FOR (IN-GROUND):**

1. Attach Chair Pipe Ass'y to Main Post Ass'y using Nut Cap, Nylon Nut, M12 Lock Washer, M12 Washer, M12 Cap Washer, M12 Large Washer, Square Washer, Spacer, and Square Bar and Main Shaft Ass'y. See Chair Pipe Ass'y Detail.
2. Dig holes or drill holes according to Plan View and Elevation View. **NOTE:** Due to extremes in weather and soil conditions, hole size may have to be increased to meet local conditions.
3. Attach the Footbuck Weld Assembly to the Leg Press using 3/4" Hex Nut, 3/4" Lockwasher, 3/4" Flatwasher (2" O.D.), 3/4" x 2" Hex Head Cap Screw. See In-Ground Assembly Detail.
4. Place Leg Press into hole making sure it rests on the brick. See In-Ground Detail.
5. Level Leg Press using sway bracing.
6. Pour concrete according to the Plan View and Elevation View. Allow concrete to cure for a minimum of 7 days.
7. Attach Base Cover to Equipment Post using Base Cover Detail.

**398-7009 LEG PRESS (FOOTING)**

**398-7009 LEG PRESS (IN GROUND)**

**398-7009 LEG PRESS (SURFACE)**

**INSTALLATION INSTRUCTIONS FOR (SURFACE):**

1. Attach Chair Pipe Ass'y to Main Post Ass'y using Nut Cap, Nylon Nut, M12 Lock Washer, M12 Washer, M12 Cap Washer, M12 Large Washer, Square Washer, Spacer, and Square Bar and Main Shaft Ass'y. See Chair Pipe Ass'y Detail.
2. Mark correct location of holes for Wedge Anchor using the Base Plate as a guide.
3. Drill 3/4" x 2 1/2" hole in concrete for Wedge Anchor. See Surface Detail.
4. Insert Wedge Anchors and secure with 3/4" Flatwasher (2" O.D.), 3/4" Lockwasher, and 3/4" Hex Nut. See Surface Assembly Detail.
5. Attach Base Cover to Equipment Post using Base Cover Detail.

**MAINTENANCE PROCEDURE:**

Periodically check hardware for tightness, and tighten as necessary. Always check all parts for breakage or wear, and immediately put equipment out of service until any faulty parts found are repaired or replaced. Also Check all metal parts for rust, paint loss and touch-up if necessary with paint. Check for welded areas and verify integrity. Check periodically resilient surfacing for appropriate depth and remove extraneous materials that could cause injury, infection, or disease. Maintain detailed installation, inspection, maintenance, and repair records for each public-use playground equipment.

**398-7009 LEG PRESS (FOOTING)**  
**398-7009 LEG PRESS (IN GROUND)**  
**398-7009 LEG PRESS (SURFACE)**

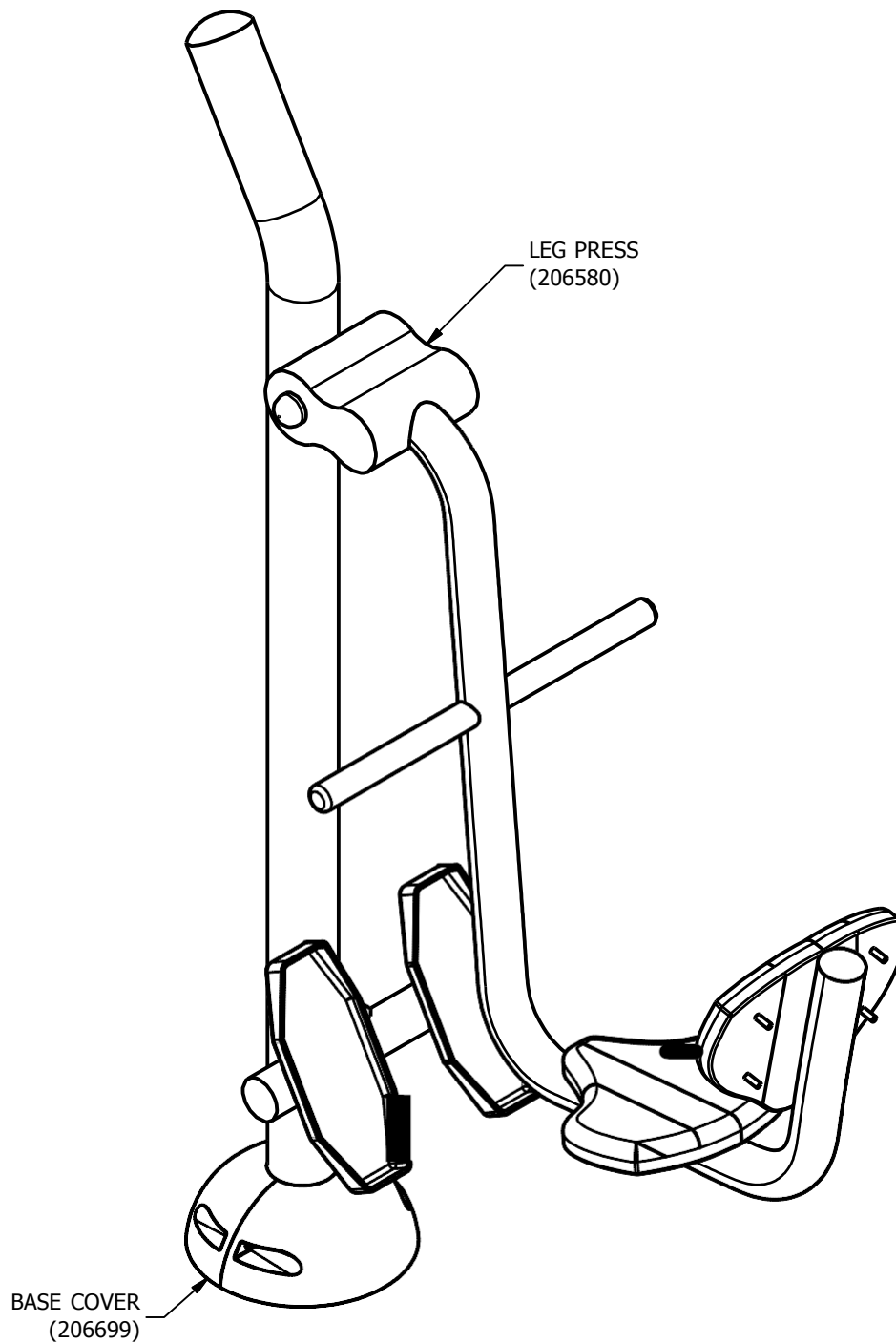

**FINISHED ASSEMBLY**

**398-7009 LEG PRESS (FOOTING)**  
**398-7009 LEG PRESS (IN GROUND)**  
**398-7009 LEG PRESS (SURFACE)**

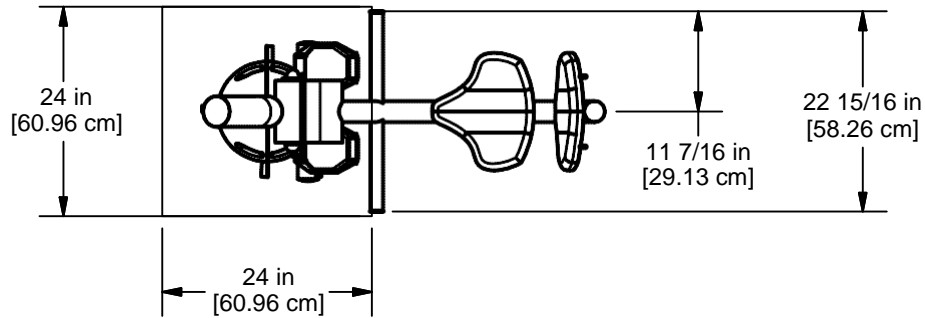

**PLAN VIEW**  
**(FOOTING)**

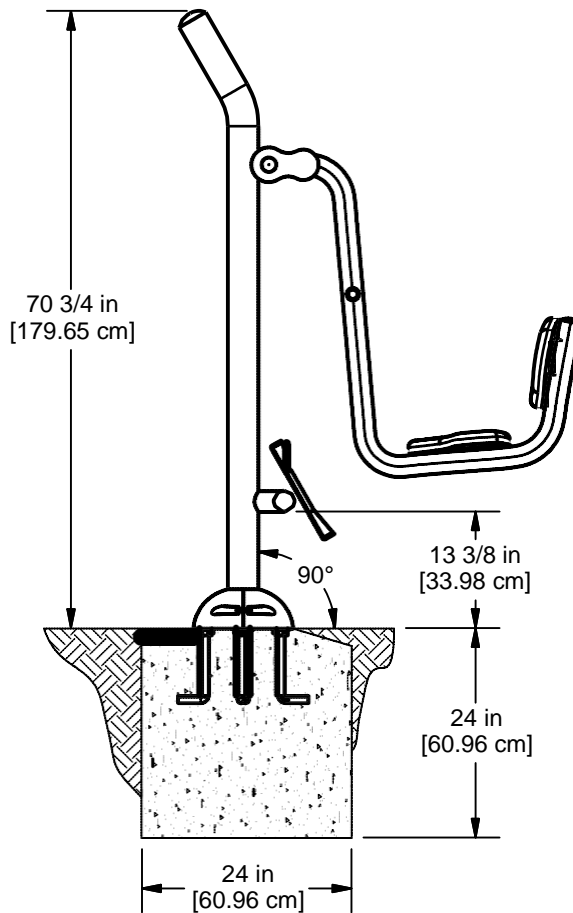

**ELEVATION VIEW**  
**(FOOTING)**

**398-7009 LEG PRESS (FOOTING)**  
**398-7009 LEG PRESS (IN GROUND)**  
**398-7009 LEG PRESS (SURFACE)**

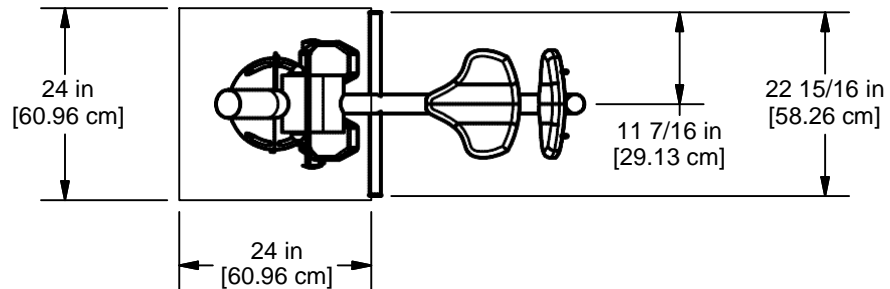

**PLAN VIEW**  
**(IN GROUND)**

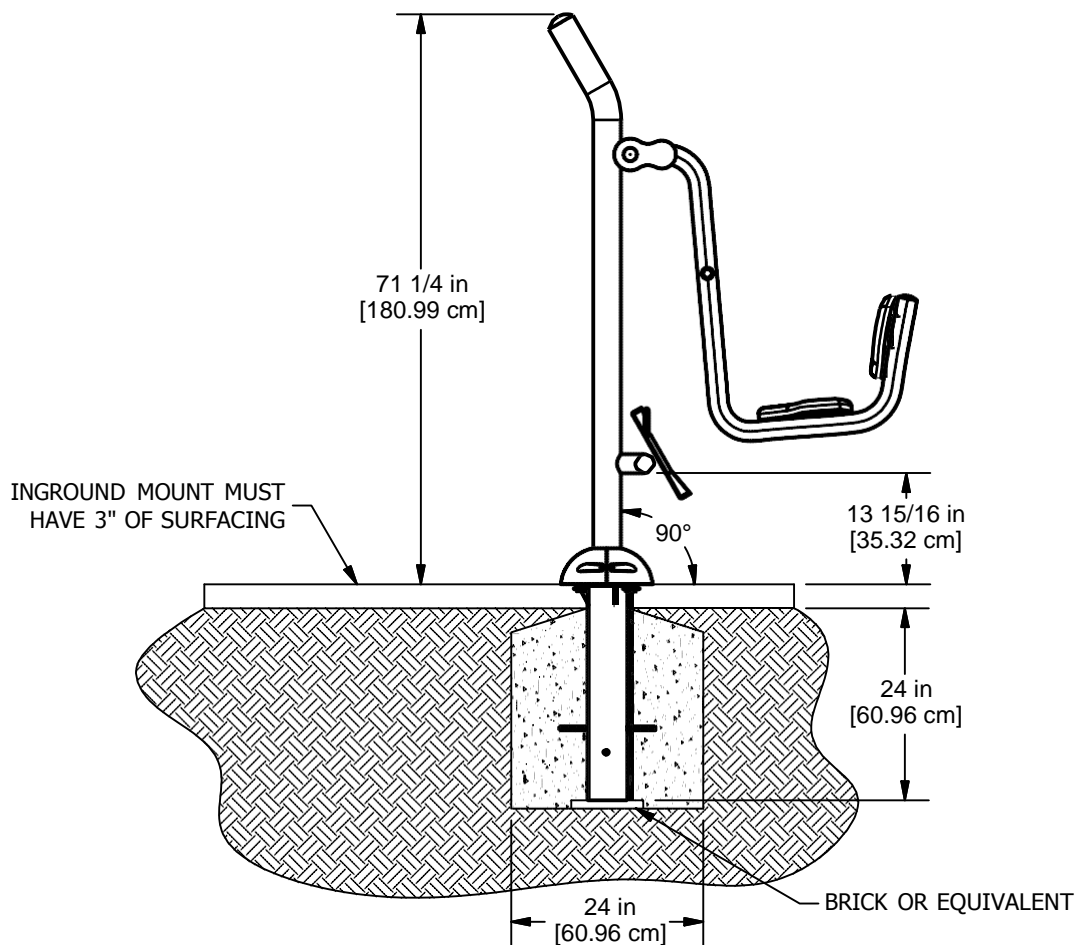

**ELEVATION VIEW**  
**(IN GROUND)**

**398-7009 LEG PRESS (FOOTING)**  
**398-7009 LEG PRESS (IN GROUND)**  
**398-7009 LEG PRESS (SURFACE)**

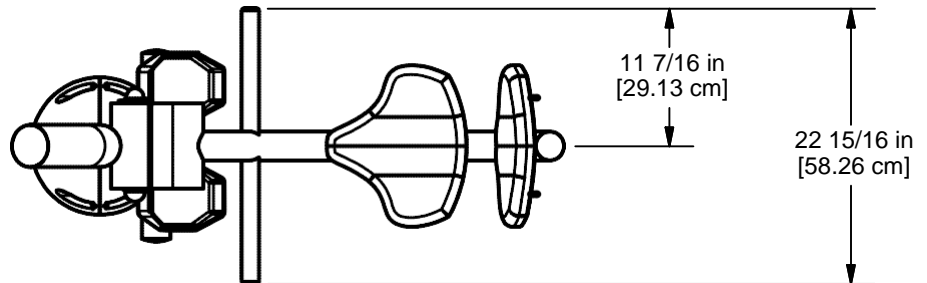

**PLAN VIEW**  
**(SURFACE)**

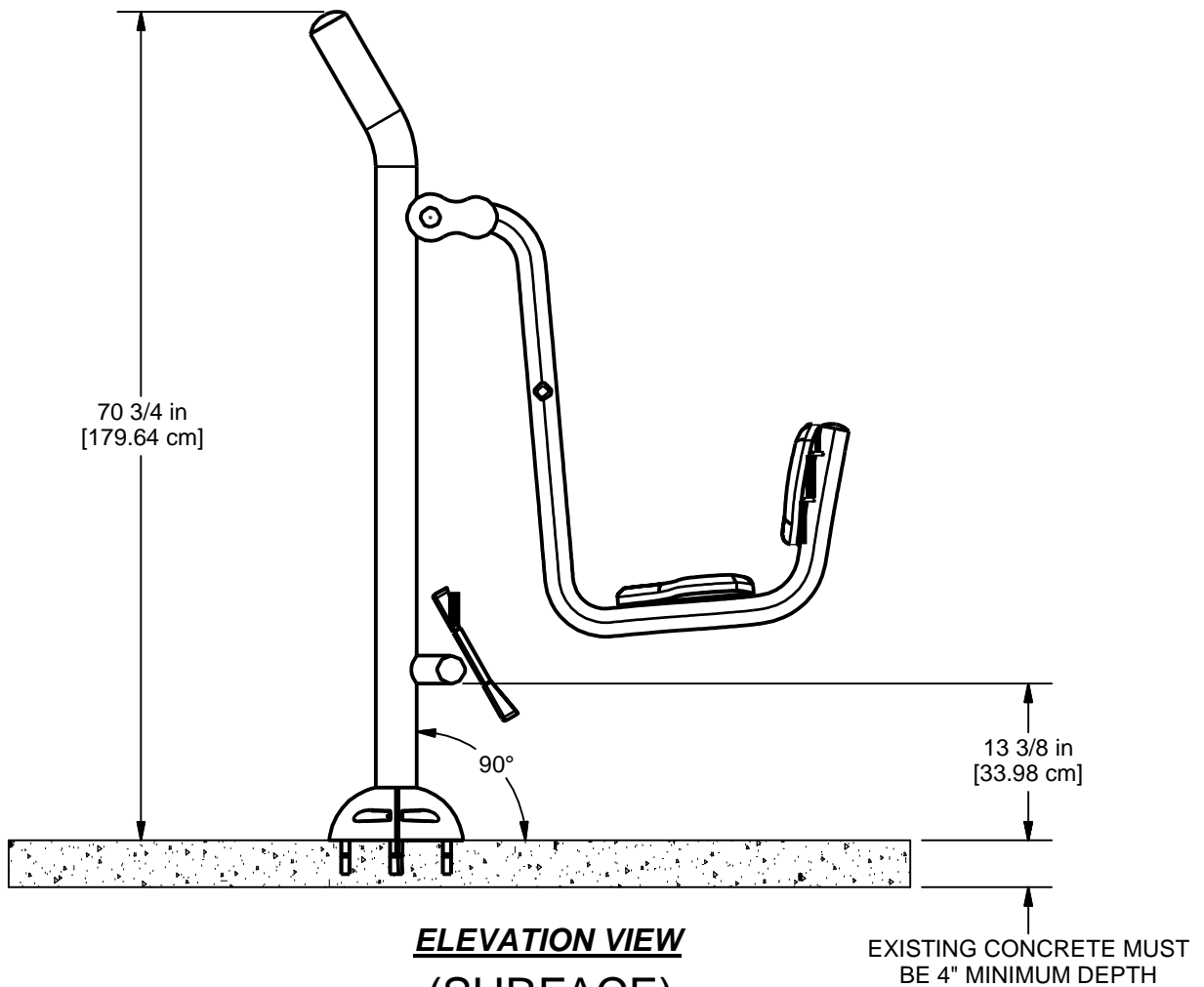

**ELEVATION VIEW**  
**(SURFACE)**

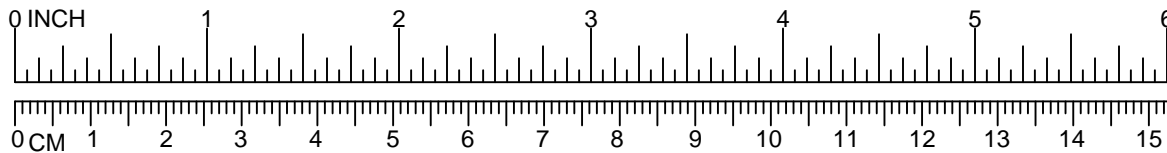

**398-7009 LEG PRESS (FOOTING)**

**398-7009 LEG PRESS (IN GROUND)**

**398-7009 LEG PRESS (SURFACE)**

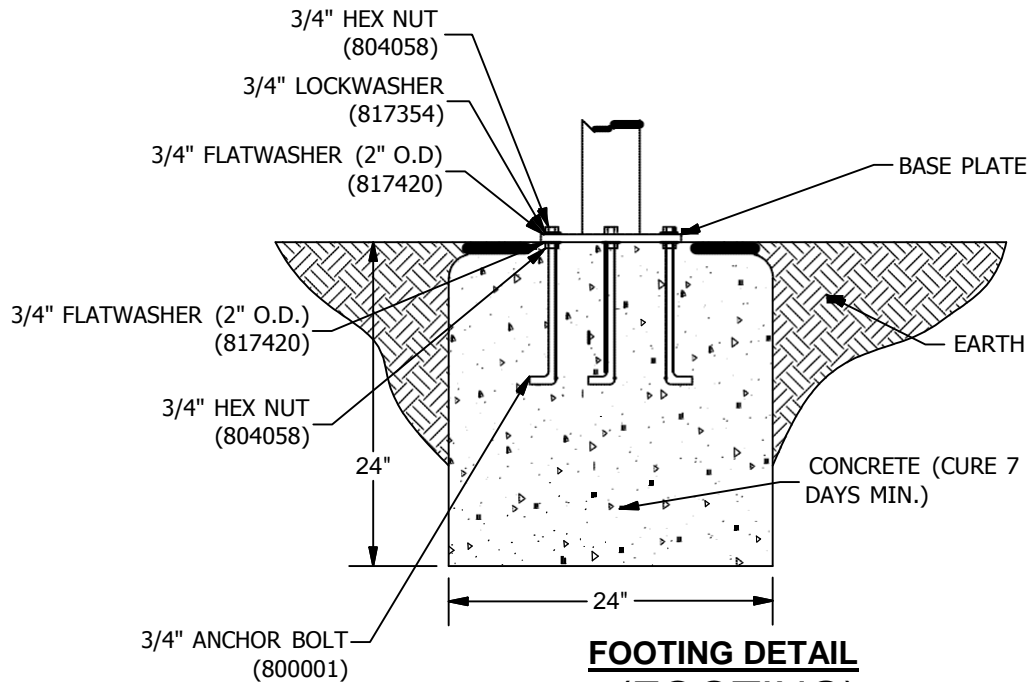

CONCRETE REQUIRED:  
.30 CUBIC YARDS  
.23 CUBIC METERS

NOTE:  
-SLOPED FOOTING IS A REQUIREMENT OF EUROPEAN STANDARD EN1176-1 ONLY.  
-SUGGESTED MINIMUM CONCRETE RATING 3000 PSI

**FOOTING DETAIL**  
**(FOOTING)**

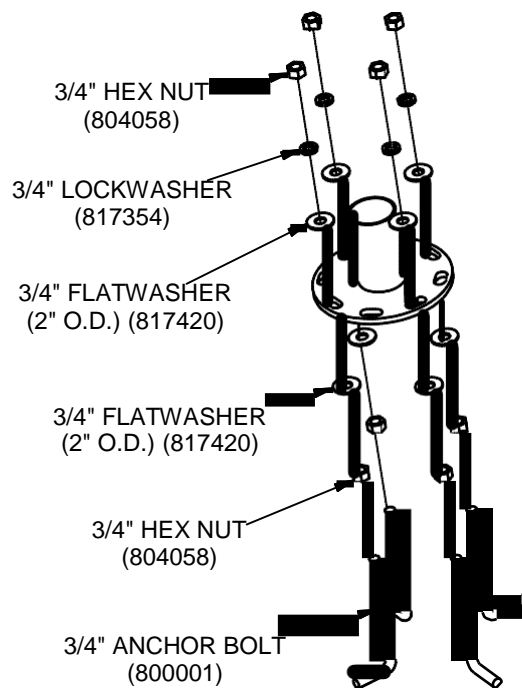

**FOOTING ASSEMBLY DETAIL**  
**(FOOTING)**



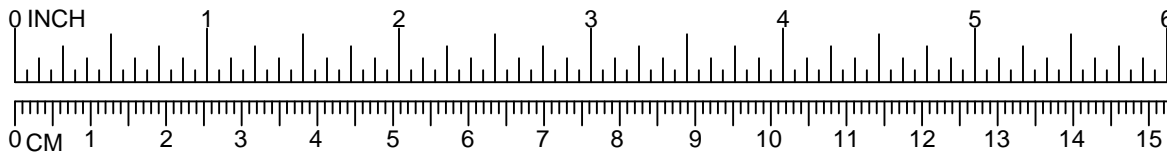

### 398-7009 LEG PRESS (FOOTING)

### 398-7009 LEG PRESS (IN GROUND)

### 398-7009 LEG PRESS (SURFACE)

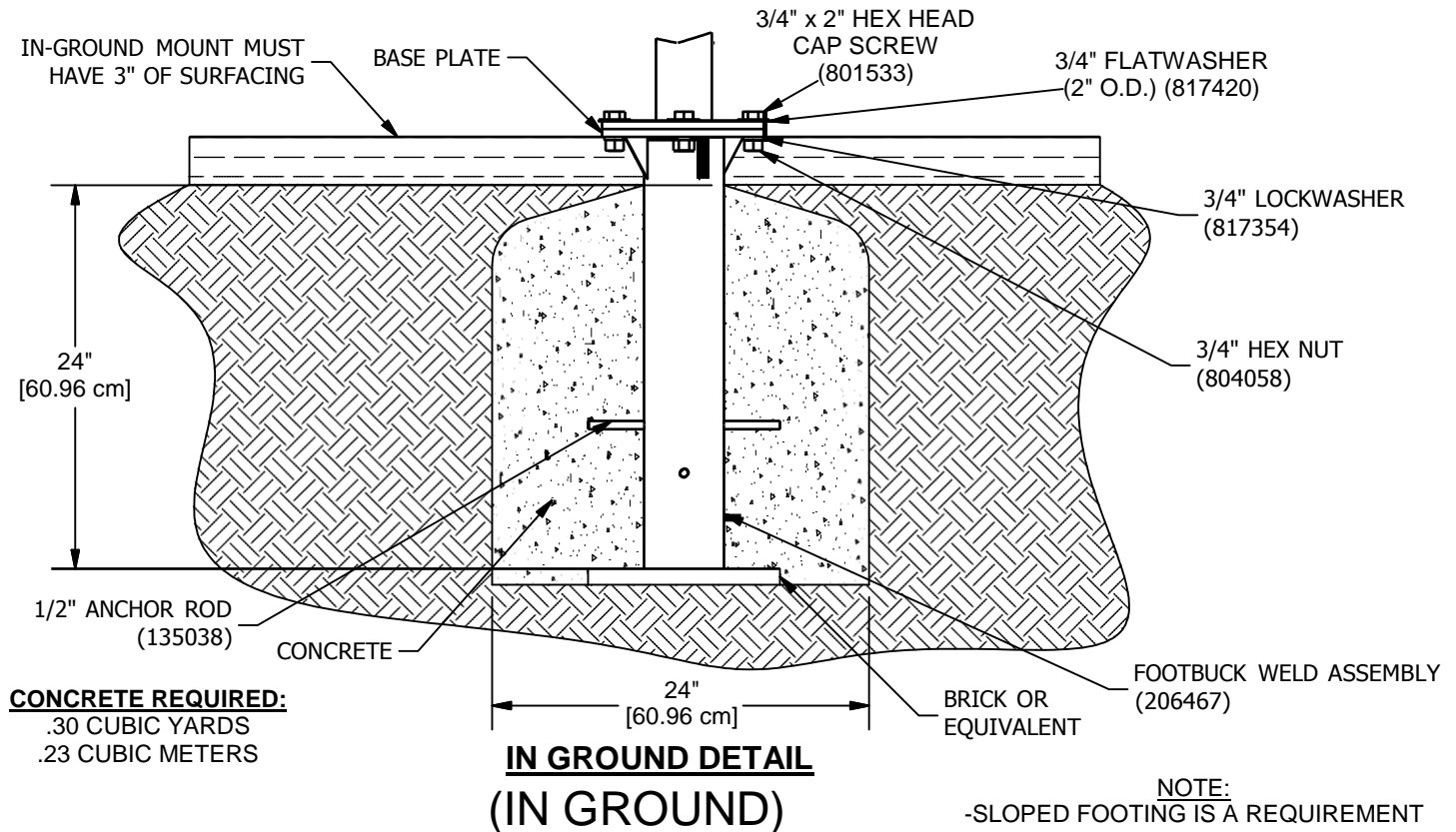

**NOTE:**  
-SLOPED FOOTING IS A REQUIREMENT OF EUROPEAN STANDARD EN1176-1 ONLY.  
-SUGGESTED MINIMUM CONCRETE RATING 3000 PSI.

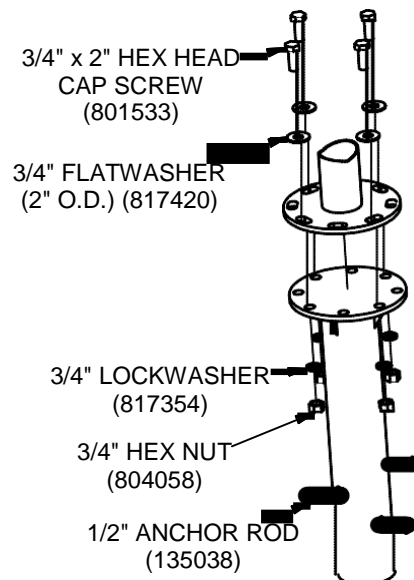

### **IN GROUND ASSEMBLY DETAIL** **(IN GROUND)**

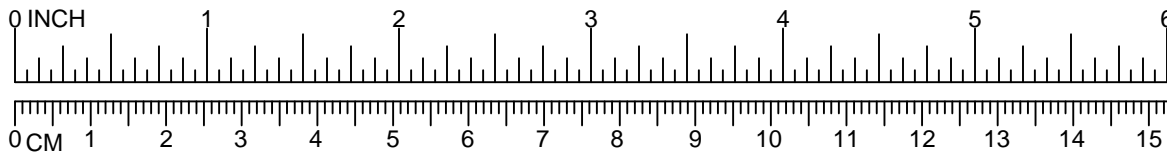

**398-7009 LEG PRESS (FOOTING)**

**398-7009 LEG PRESS (IN GROUND)**

**398-7009 LEG PRESS (SURFACE)**

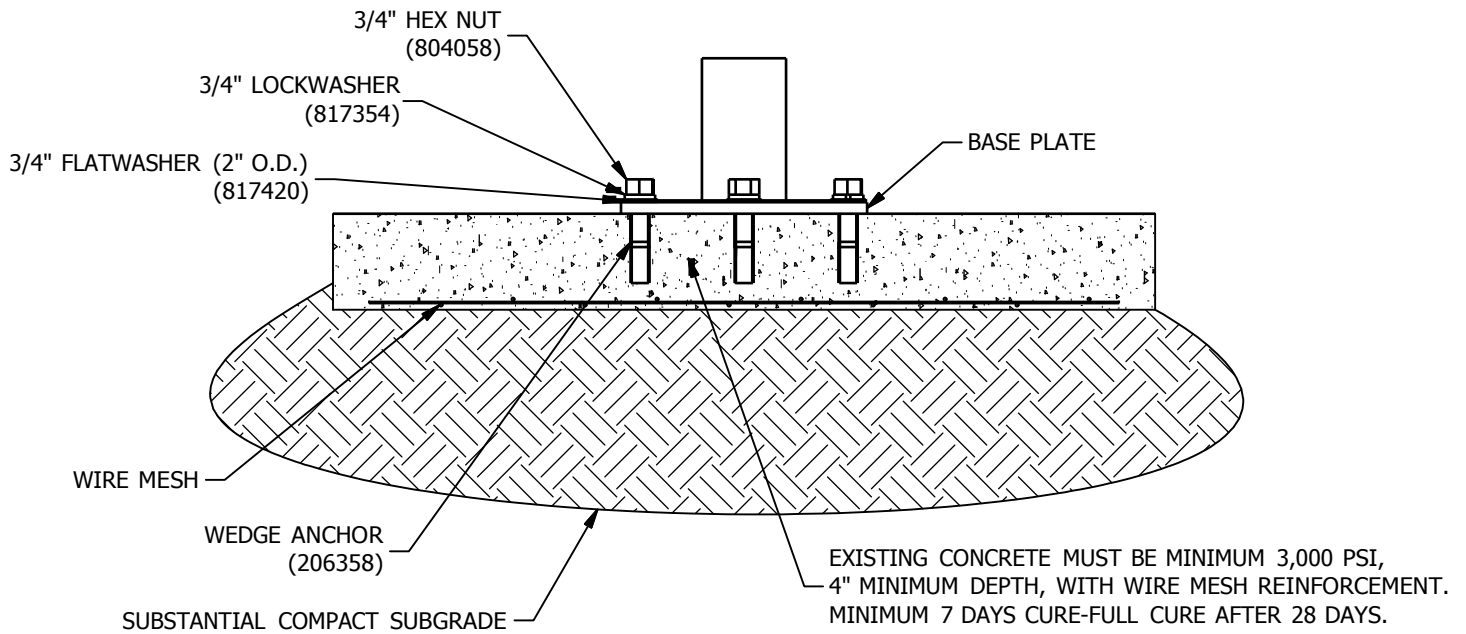

**SURFACE DETAIL**  
**(SURFACE)**

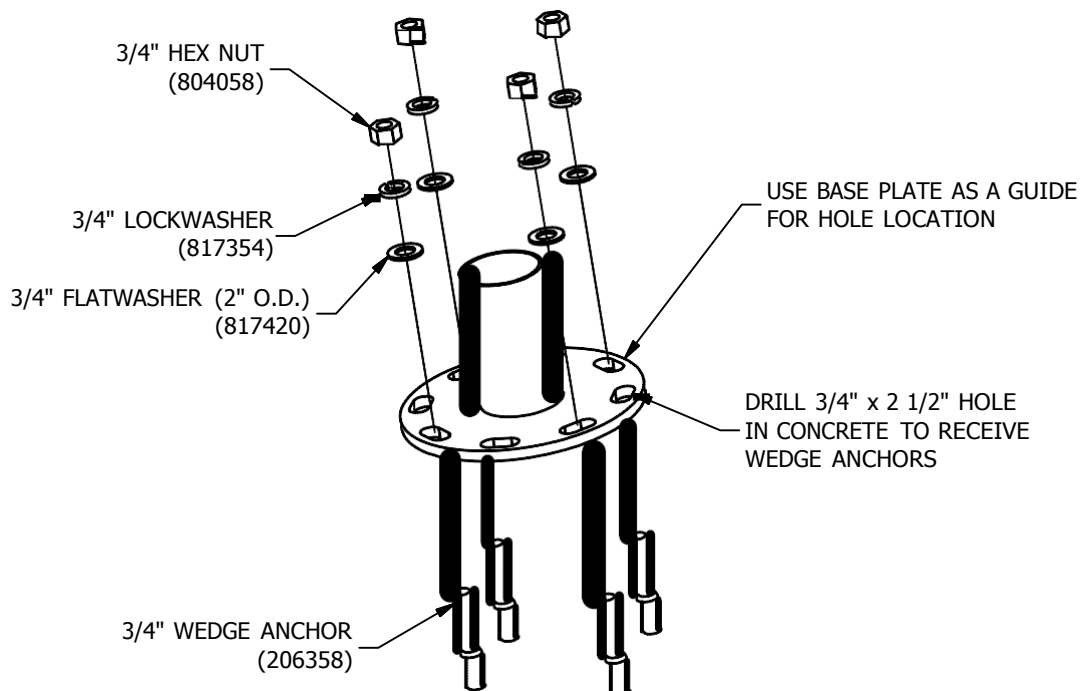

**SURFACE ASSEMBLY DETAIL**  
**(SURFACE)**

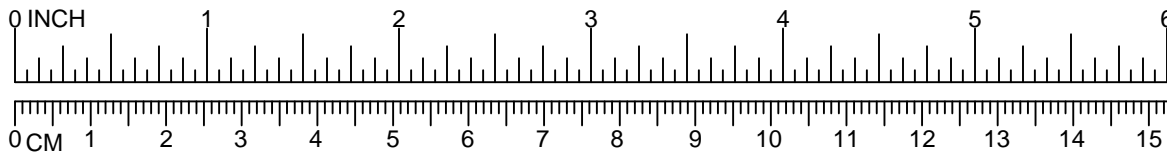

**398-7009 LEG PRESS (FOOTING)**

**398-7009 LEG PRESS (IN GROUND)**

**398-7009 LEG PRESS (SURFACE)**

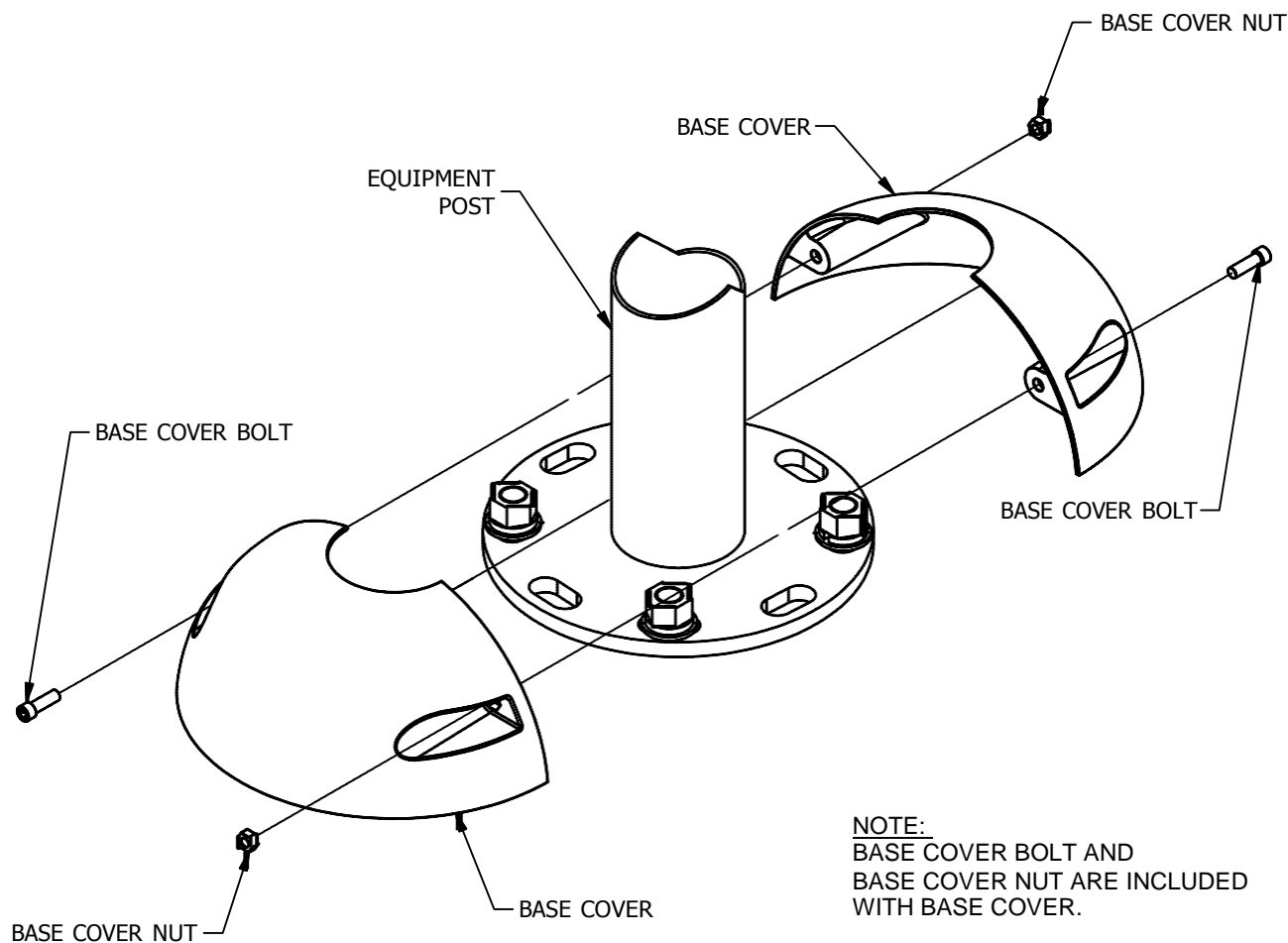

**BASE COVER DETAIL**

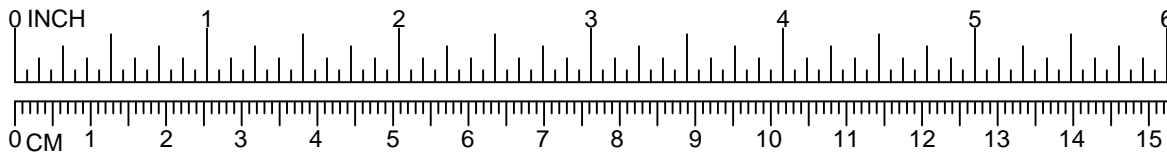

**398-7009 LEG PRESS (FOOTING)**  
**398-7009 LEG PRESS (IN GROUND)**  
**398-7009 LEG PRESS (SURFACE)**

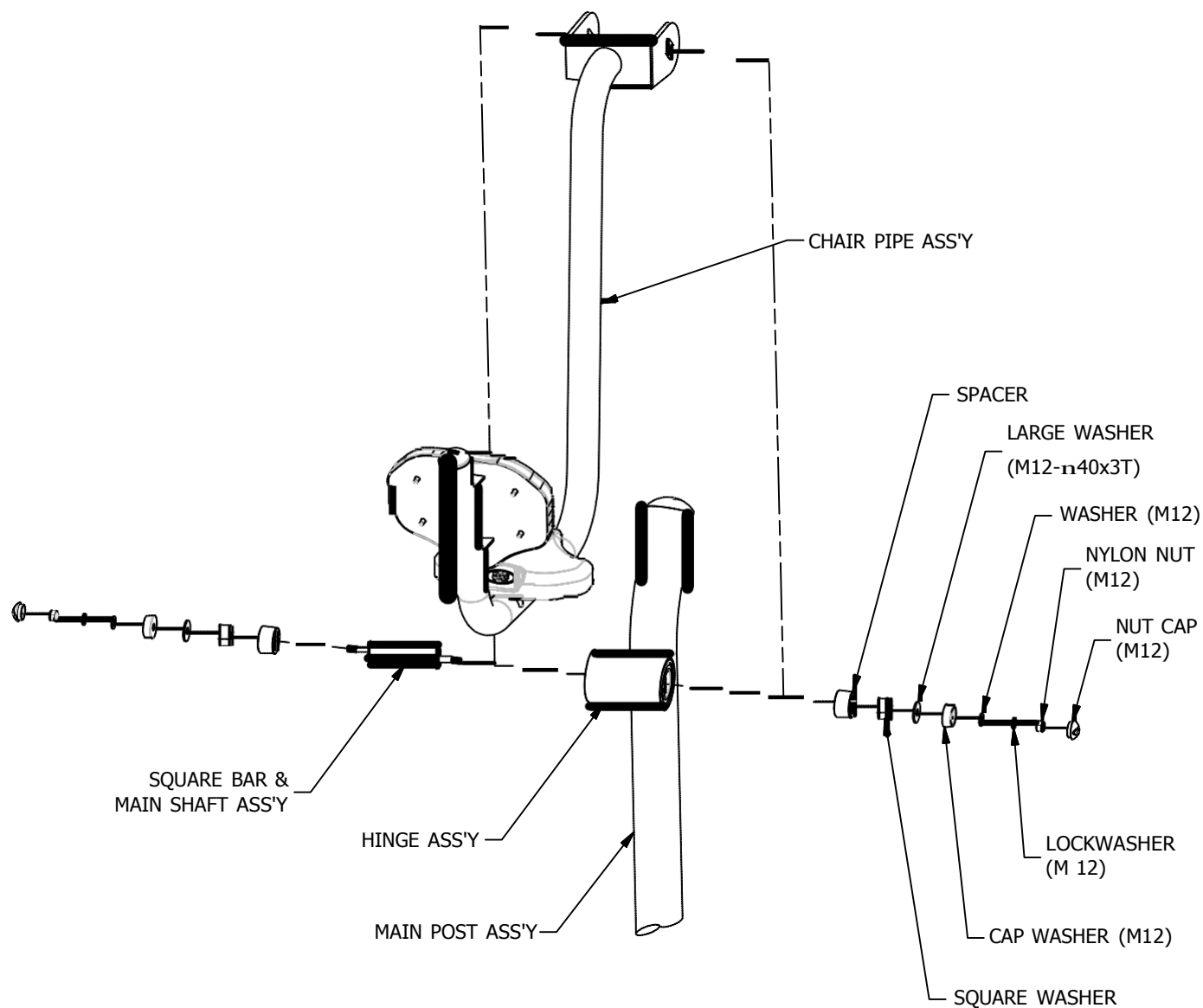

**CHAIR PIPE**  
**ASSEMBLY DETAIL**