

398-7016 HORIZONTAL CHIN-UP

Parts List		
DESCRIPTION	QTY	PART NUMBER
HORIZONTAL CHIN-UP BAR	1	207114
TOP COVER	1	403362
18" PLYOMETRIC FRAME	1	403372
UPRIGHT	2	LIX736
HARDWARE COMPLETE	1	403483
HORIZONTAL CHIN-UP NAME PLATE	1	403431
3/8" x 3/4" P.B.H.C.S. w/PATCH	4	812052
3/8" x 1 1/4" B.H.C.S.	4	811051
3/8" LOCKWASHER	8	817334
3/8" BARREL NUT	4	804804
3/8" FLAT WASHER	4	817410
1/2" ANCHOR ROD	3	135038

Unless Otherwise Specified, All Units of Measure are Each

Items listed below Hardware Complete line are included with Hardware Complete Number

Warning: During Installation, Hardware And Small Parts Are Choking Hazards For Young Children. Store Unused Parts Appropriately Until Assembly Is Completed. Once Assembly Is Completed, Remove Any Unused Parts From The Play Environment And Dispose/Save Them In A Secure Location. Any bolt end protruding more than two full threads beyond the face of the nut causes risk of clothing entanglement. Promptly cut-off flush, file smooth, and treat to prevent corrosion.

Note: Peen Tee-Nuts and Flatwashers to match radius of pipe after assembly is complete.

Note: Loctite (supplied by others) should be used on any non-patch hardware.

SPECIFICATIONS:

Top cover: Shall be 3/4" HDPE Densetec Anti-skid Diamond Texture Sheet.

Plyometric Frame: Shall have a 5" (.12w) galvanized pipe with a 12Ga. hot rolled steel top.

Uprights - Aluminum The posts shall be 3 1/2" O.D. with a 0.125" wall thickness 6061-T6 extruded seamless Aluminum tubing conforming to ASTM B-221 and QQ-A 200/8. Tensile strength is 44,962 psi, and yield strength is 39,885 psi. Entire post is polyester powder-coated after fabrication. A cast aluminum cap of matching color is factory riveted into the top end using two aluminum rivets.

Horizontal Chin-Up Bar : The Horizontal Chin-Up Bar assembly shall be constructed of 1.315" O.D. (12 GA) galvanized pipe and 3/16" stainless steel tabs. The Crossbar shall be an all welded construction and coated with a custom formula of TGIC polyester powder coating after fabrication.

Hardware: All nuts, bolts, screws, and lock washers used in the assembly shall be stainless steel, yellow dichromate plated steel, blue-coat plated steel, mechanically galvanized or powder coated/yellow dichromate plated steel. All primary fasteners shall be 304 alloy stainless steel. Fasteners with yellow dichromate treatment have an electro-deposited, 99.9% pure zinc substrate applied from a specially formulated solution sealed with a yellow dichromate top coat designed to work in conjunction with the zinc plating.

398-7016 HORIZONTAL CHIN-UP

INSTALLATION INSTRUCTIONS:

1. Dig footing holes as shown in Plan and Elevation Views. Place brick or equivalent in the bottom of hole to provide a solid foundation.
2. Attach Top Cover to Plyometric Frame using 3/4" P.B.H.C.S. w/Patch, 3/8" Lock Washer, 3/8" Flat Washer and 3/8" Barrel Nut. See detail 684. **IMPORTANT:** *Make sure to when attaching the Top Cover to place the Densetec Anti-skid Diamond Texture facing up.*
3. Attach 1/2" Anchor Rod to Plyometric Frame. See detail 231.
4. Attach the Horizontal Chin Up Bar to the Uprights using 3/8" x 1 1/4" B.H.C.S. w/Patch, 3/8" Lockwasher. See detail 086.
5. Attach the Horizontal Chin-Up Name Plate to the Upright using Pop Rivet. See Detail 322.
6. Attach 1/2" Anchor Rod to Upright. See detail 231.
7. Plumb and level the entire assembly and tighten all fasteners.
8. After entire unit is assembled, pour concrete footings within 4" to the top and taper away from posts for water drainage. Allow to cure at least 48 hours before use. Note: Temporary bracing may be required until concrete cures.
9. When the structure is finished and satisfactory, eliminate sharp points and sharp edges (burring) on installed hardware like bolts, nuts, etc.

MAINTENANCE PROCEDURE:

Periodically check hardware for tightness, and tighten as necessary. Always check all parts for breakage or wear, and immediately put equipment out of service until any faulty parts found are repaired or replaced. Also Check all metal parts for rust, paint loss and touch-up if necessary with paint. Check for welded areas and verify integrity. Check periodically resilient surfacing for appropriate depth and remove extraneous materials that could cause injury, infection, or disease. Maintain detailed installation, inspection, maintenance, and repair records for each public-use playground equipment.

398-7016 HORIZONTAL CHIN-UP

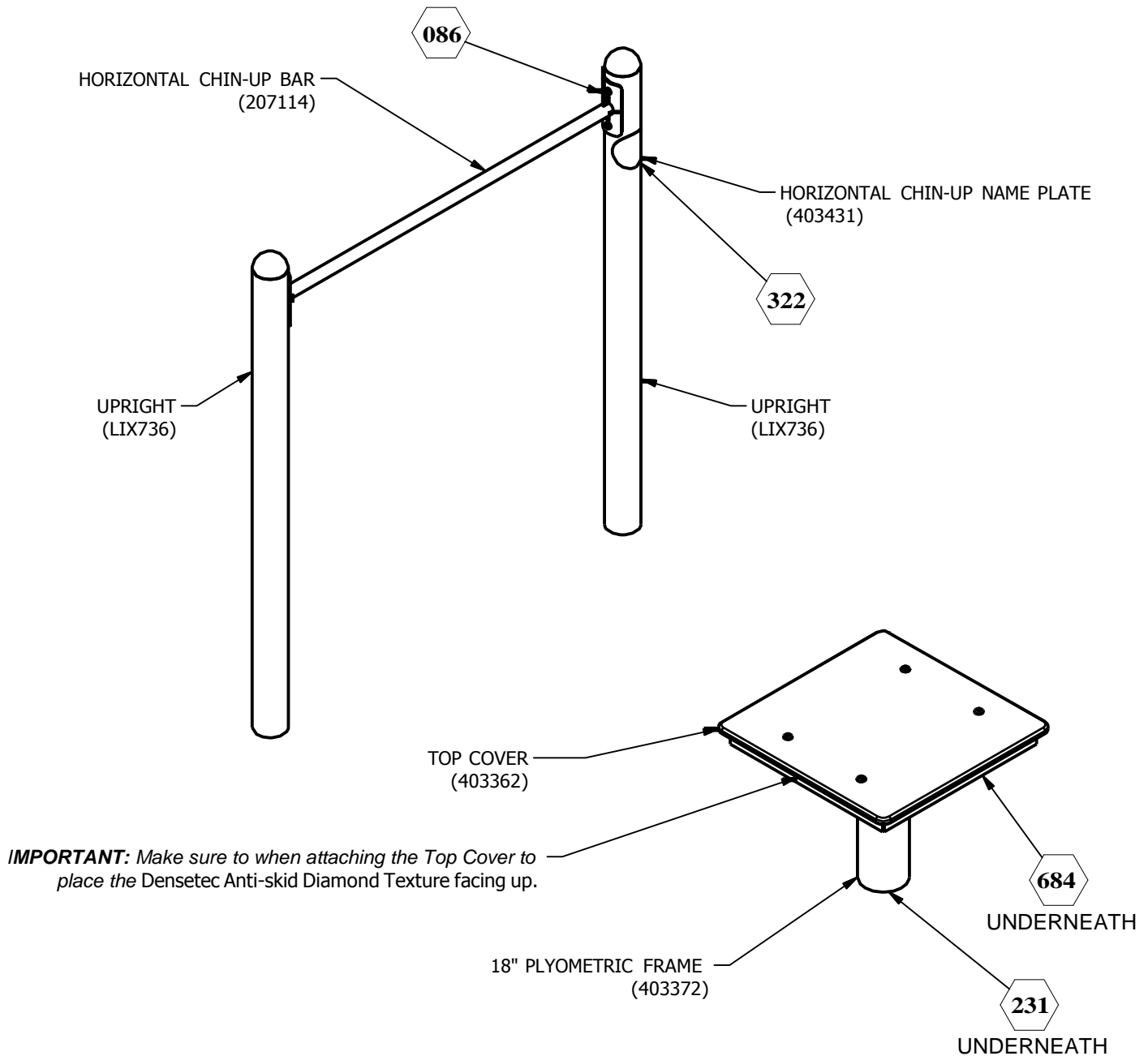

 = INSTALLATION DETAIL

FINISHED ASSEMBLY

398-7016 HORIZONTAL CHIN-UP

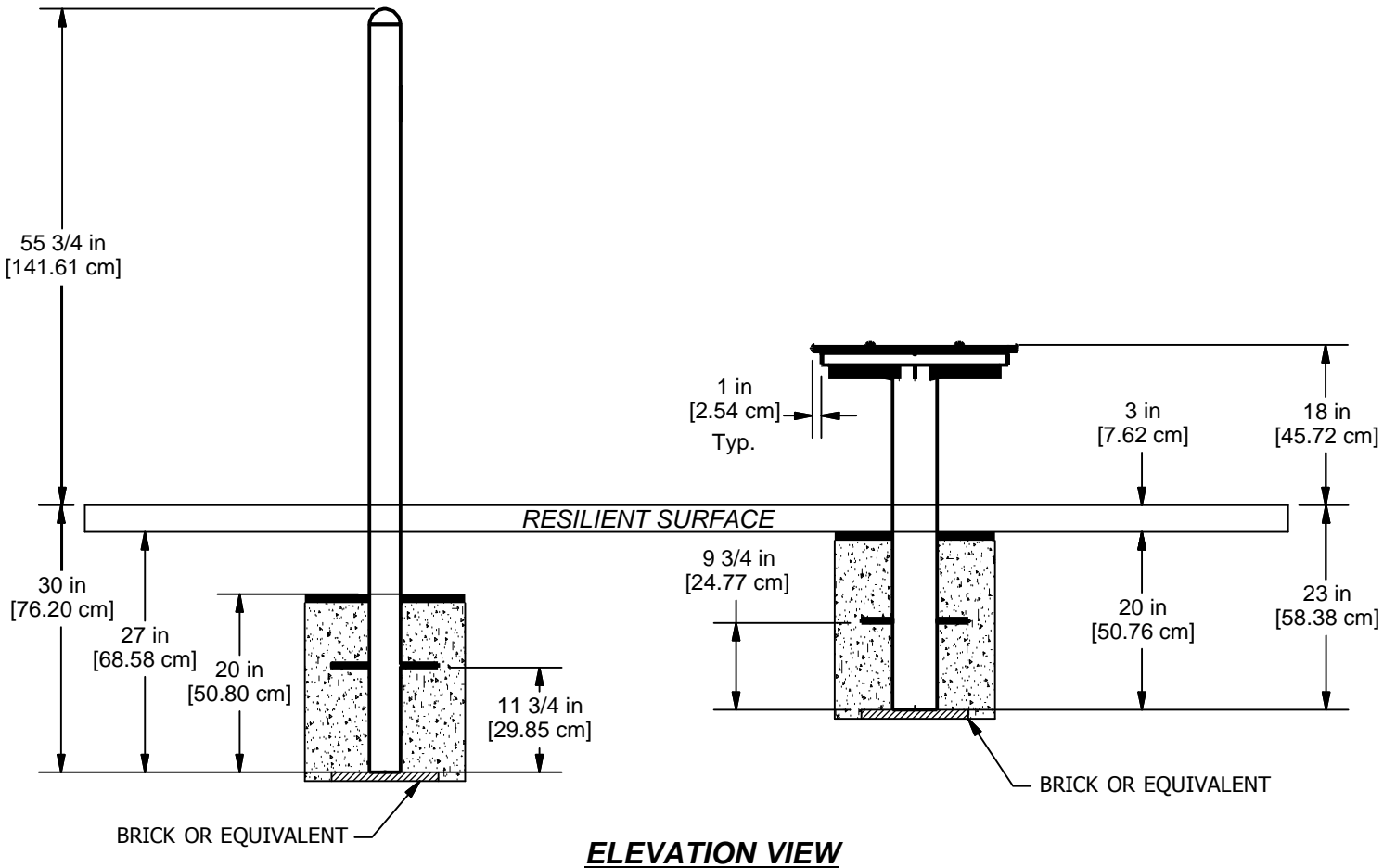
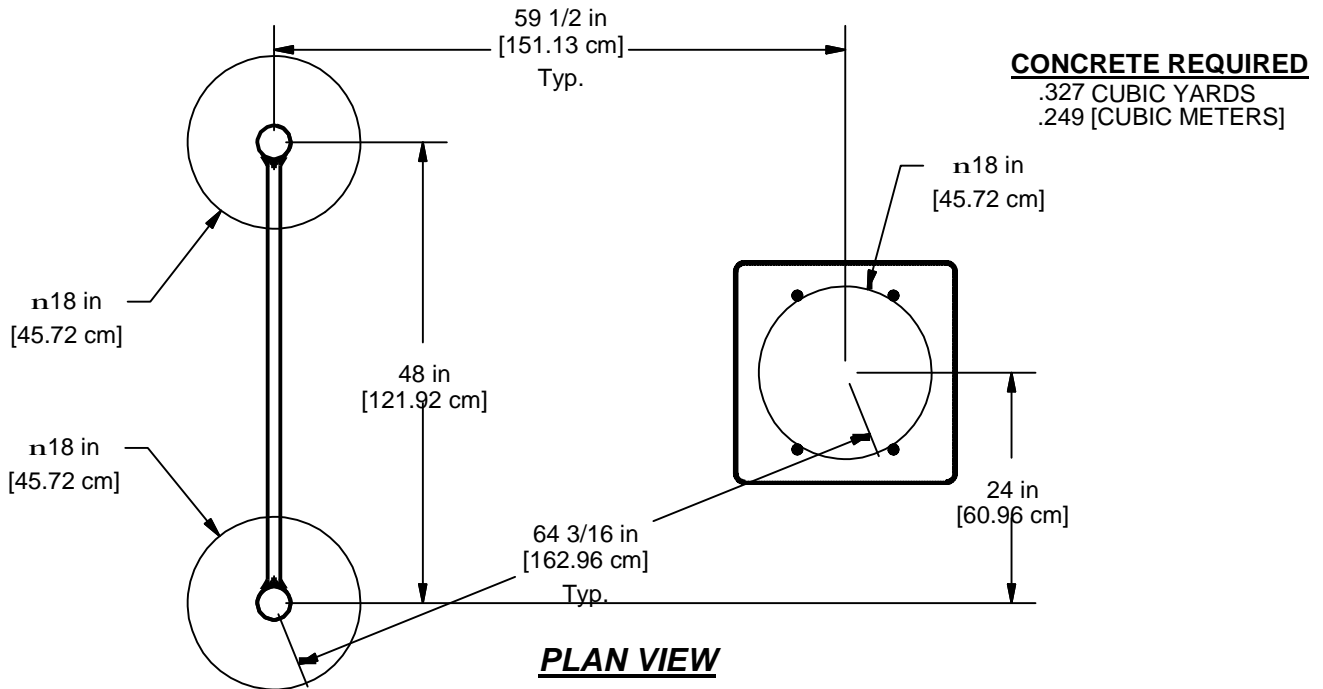

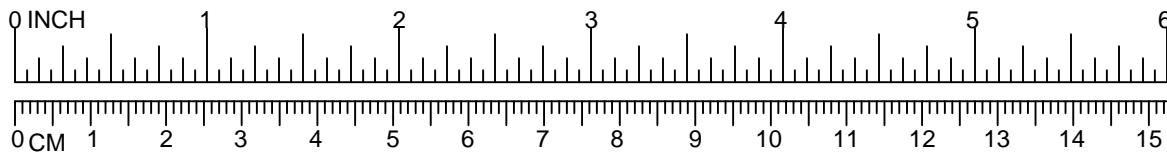

398-7016 HORIZONTAL CHIN-UP

IMPORTANT: Make sure when attaching the Top Cover to place the Densetec Anti-skid Diamond Texture facing up.

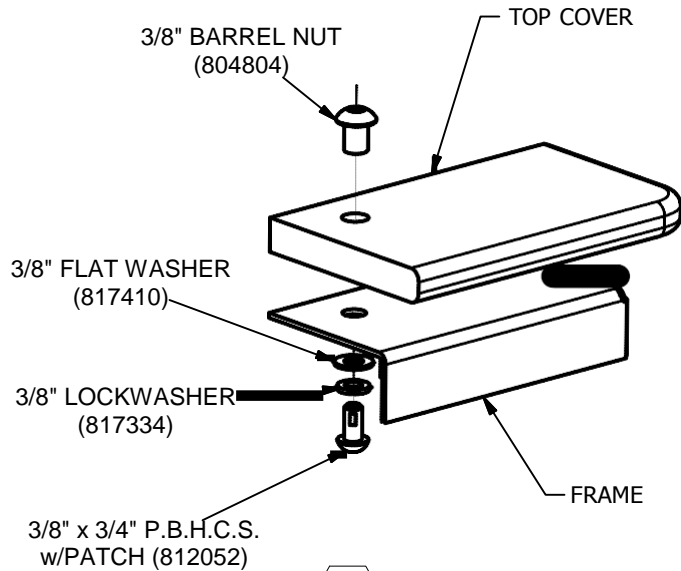

684

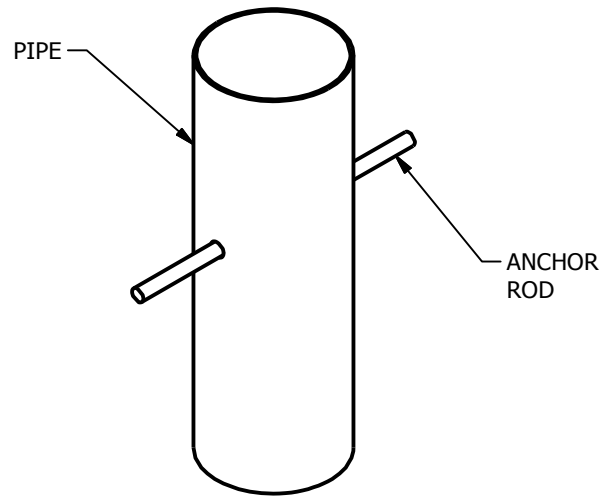

231

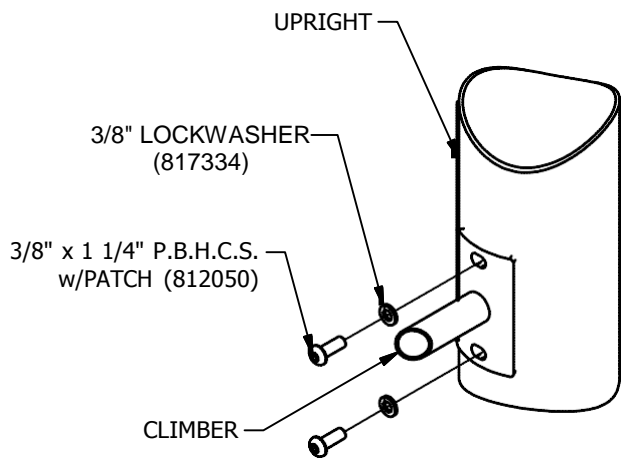

086

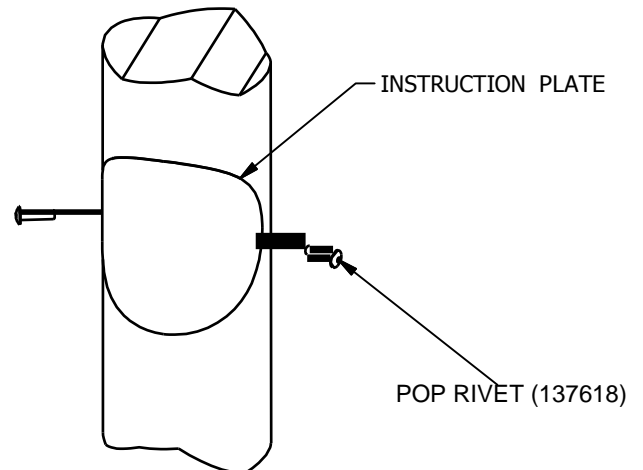

322