

# PRODUCT SPECIFICATIONS

## TOWNSHIP BUS SHELTER

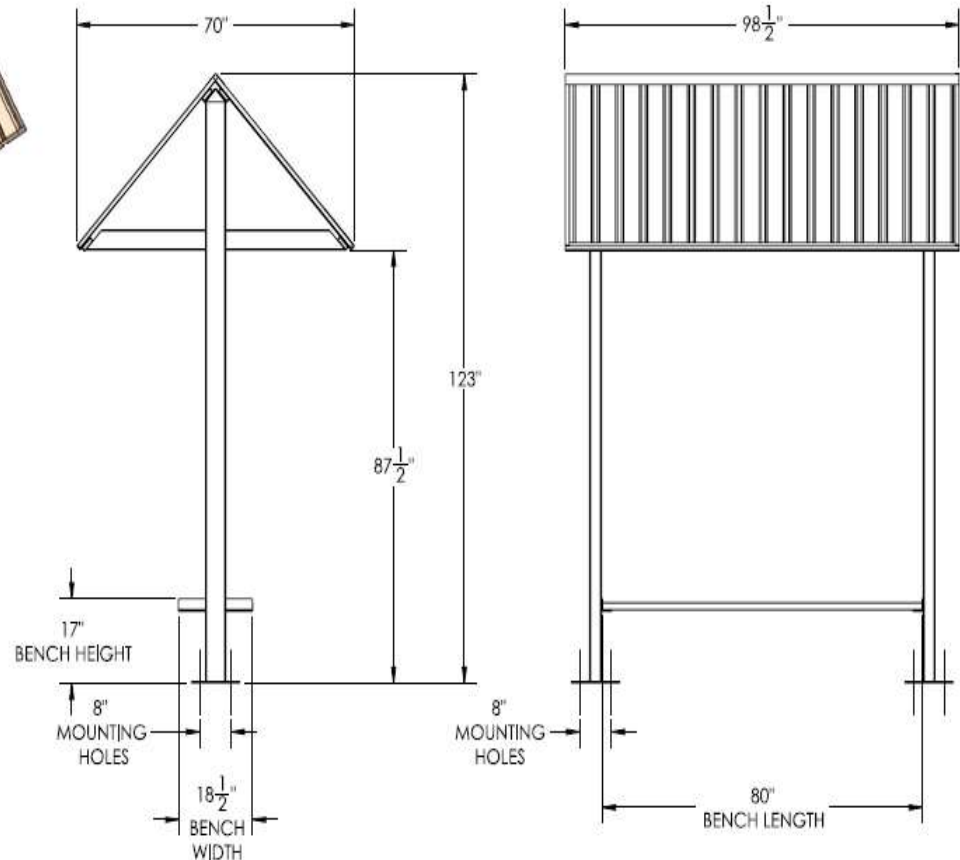

- All metal fabricated parts are etched, phosphatized, preheated, primer powder coated, and final coat electrostatically powder coated.
- Colors include: Black, Evergreen, Dark Green White, Tan, Dark Brown, and Blue.
- Special order colors available.
- This product can ship either knocked down or assembled.

### NOTE:

It is not recommended to locate anchor bolts until the shelter is in place. Anchor bolts not included.

