

thepark

AND FACILITIES
C A T A L O G

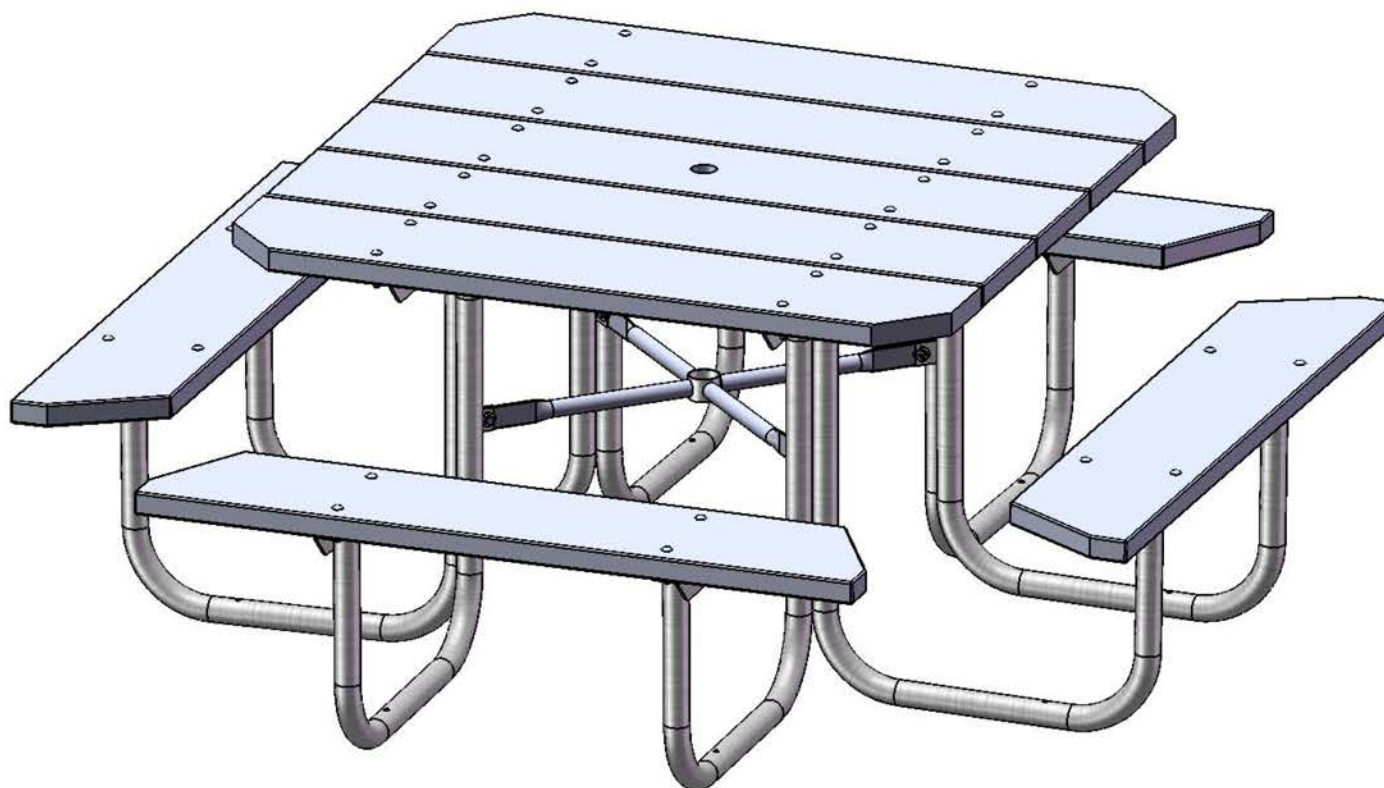

Model No. 398-1466



3350 NW Boca Raton Blvd., Suite B2
Boca Raton, FL, 33431
1-866-280-9894

WARRANTY & TERMS

WARRANTY: 5 Year Limited Warranty on Thermoplastic coated elements. The Park and Facilities Catalog guarantees all items for one full year to be free of defects in workmanship or materials when installed and maintained properly. We agree to repair or replace, any items determined to be defective. Items specifically not covered by this warranty include vandalism, man made or natural disasters, lack of maintenance, normal weathering or wear and tear due to public abuse.

Damages or loss in transit is the responsibility of the carrier, whether visible or concealed. It is the responsibility of the recipient to assure that the order is received complete. Before signing the delivery receipt, inspect the shipment immediately and completely. Note any damages or shortages on the bill of lading. Damage reports must be filed within 10 days. The Park and Facilities Catalog is NOT responsible for damages or loss in transit. Title to all goods passes to the customer at the time of shipment. The Park and Facilities Catalog will assist in filing claims if the freight arrangements were made by The Park and Facilities Catalog at your request.

CANCELLATIONS AND RETURNS: Cancellations are only accepted with approval of The Park and Facilities Catalog. No merchandise shall be returned without a Return Goods Authorization number which is issued by customer service. Any authorized merchandise must be carefully packed and received in saleable condition. A restocking charge of up to 25% will be applied to all returned goods when the error is not the fault of The Park and Facilities Catalog. All returns must be shipped freight prepaid.



SAFETY WARNINGS & EQUIPMENT INSPECTION

- Owners and installers please note these safety warnings and make use of this checklist on a regular basis.
- Follow installation instructions when erecting equipment.
- Ground surfaces around equipment should be restored as needed. Concrete footings should never be exposed. Surface depth should comply with ASTM and CPSC specifications.
- Check for and repair damage caused by wear or vandalism, a major factor in injury causing situations.
- All protruding bolts should be covered or cut off and finished smooth. Sharp edges on pipes should be capped or removed. Check for bent, broken, or severely worn pipe, and replace.
- All equipment should be free of rust and repainted whenever necessary to deter rusting.
- We provide our customers with layout sheets and installation instructions. Please keep on file the specifications sheet that contains the listing of every part used.
- Never add components not intended for use with this product.
- Regular maintenance is necessary in this and all park and recreational equipment to insure the safety of the user.
- Note: Proper maintenance of equipment requires regular tightening of all bolts, nuts, and setscrews.
- Note: Regular checking of all parts, castings, etc. should be made. If a part is broken or worn, it should be replaced immediately.
- Check to be sure all fittings are tight and that bars and pipes do not move.
- Replace all worn S-hooks. S-hooks must be completely closed. Failure to close S-hooks can result in serious injury to the user. NEVER reuse S-hooks.
- Test for free movement of swing hanger and other moving attached parts.
- Check for worn chains and replace them.
- A soft resilient surface should be placed under all swings extending at least twice the height of the top rail both front and back.

HARDWARE

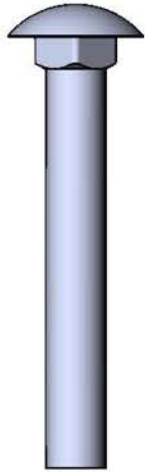

5/16" x 2-1/4"
Carriage Bolt



5/16" x 1"
Machine Bolt



3/8" x 1"
Carriage Bolt

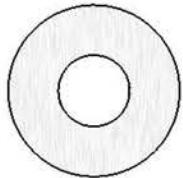

5/16" Washer

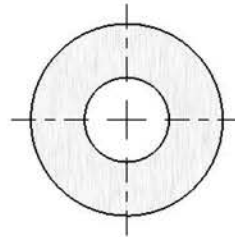

3/8" Washer



5/16" Hex Nut

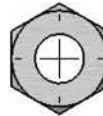

3/8" Hex Nut

TOOLS REQUIRED

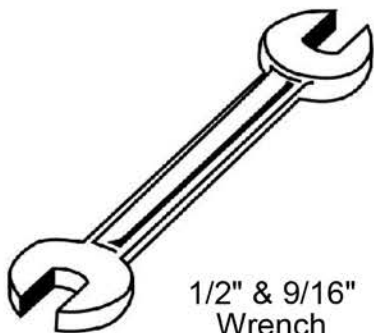

1/2" & 9/16"
Wrench

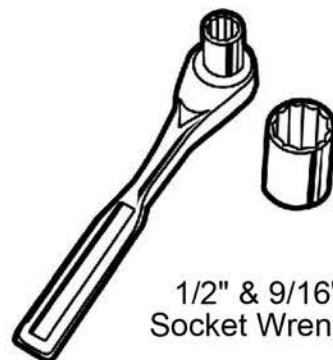

1/2" & 9/16"
Socket Wrench

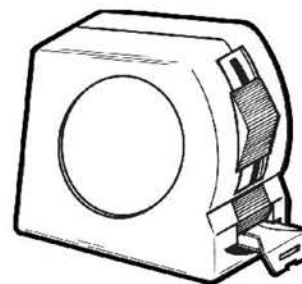

Tape Measure

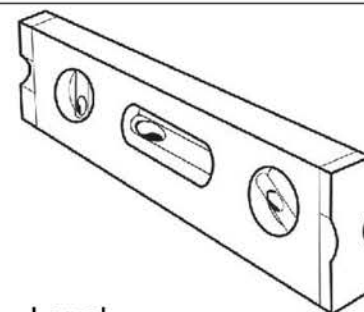

Level

48" PORTABLE TABLE WITH 4 SEATS

Top & Seats: Minimum of 96% commingled post-consumer or post-industrial recycled plastic. With a maximum of 4% due to various additives including color and UV stabilization to obtain desirable properties. Each seat is reinforced with 1/4" steel strips.

Frame: 1-5/8" O.D. x 14 gauge pre-galvanized structural steel tubing. Legs are bent over a mandrel through the bend radius producing a wrinkle free bend. Brace attachment points are 1-1/2"x2"x3/16" steel flat bar. Cross braces 1" O.D. x 16 gauge pre-galvanized structural steel tubing. The tabletop attachment angle is 2" x 2" x 3/16" formed steel angle which is mechanically fastened to the legs. Seat mounting angle is 2" x 2" x 3/16" formed steel angle which is MIG welded to the legs. All electrically MIG welded.

Frame Coating: Electrostatic powder coated application oven cured or hot dipped galvanized.

Hardware: All zinc coated steel hardware fasteners.

Dimensions: Top is 48" x 47-1/2" x 30" high. Seats are 9-1/4" x 48" long x 18" high. Outside to outside dimensions of the 4 seat table is 74-1/2" x 66-1/4".

COMPONENTS

ITEM NO.	PartNo	DESCRIPTION	QTY.
1	W358-R	358 Wood Leg - Right	4
2	W358-L	358 Wood Leg - Left	4
3	01-04-0346	358 Wood Angle Assembly	2
4	P-01-04-0122	358 Crossbrace w/ Umbrella Tube	1
5	BRN48-2x10-UT, CDR48-2x10-UT, GRN48-2x10-UT, or GRY48-2x10-UT	2 x 10 Brown Recycled Umbrella Table Plank (48"), 2 x 10 Cedar Recycled Umbrella Table Plank (48"), 2 x 10 Green Recycled Umbrella Table Plank (48"), or 2 x 10 Gray Recycled Umbrella Table Plank (48")	1
6	BRN48-2x10-MS, CDR48-2x10-MS, GRN48-2x10-MS, or GRY48-2x10-MS	2 x 10 Brown Recycled Mitered Seat Plank (48"), 2 x 10 Cedar Recycled Mitered Seat Plank (48"), 2 x 10 Green Recycled Mitered Seat Plank (48"), or 2 x 10 Gray Recycled Mitered Seat Plank (48")	4
7	BRN48-2x10-T, CDR48-2x10-T, GRN48-2x10-T, or GRY48-2x10-T	2 x 10 Brown Recycled Table Plank (48"), 2 x 10 Cedar Recycled Table Plank (48"), 2 x 10 Green Recycled Table Plank (48"), or 2 x 10 Gray Recycled Table Plank (48")	2
8	BRN48-2x10-MT, CDR48-2x10-MT, GRN48-2x10-MT, or GRY48-2x10-MT	2 x 10 Brown Recycled Mitered Table Plank (48"), 2 x 10 Cedar Recycled Mitered Table Plank (48"), 2 x 10 Green Recycled Mitered Table Plank (48"), or 2 x 10 Gray Recycled Mitered Table Plank (48")	2
9	33-06-0006	5/16" x 2 1/4" Carriage Bolt (Zinc)	36
10	33-06-0063	3/8" x 1" Carriage Bolt (Zinc)	8
11	33-02-0001	5/16" Zinc Plated Washer	44
12	33-02-0002	3/8" Zinc Plated Washer	8
13	33-01-0001	5/16" Hex Nut (Zinc)	40
14	33-01-0002	3/8" Hex Nut (Zinc)	8
15	33-05-0001	5/16" x 1" Machine Bolt (Zinc)	4

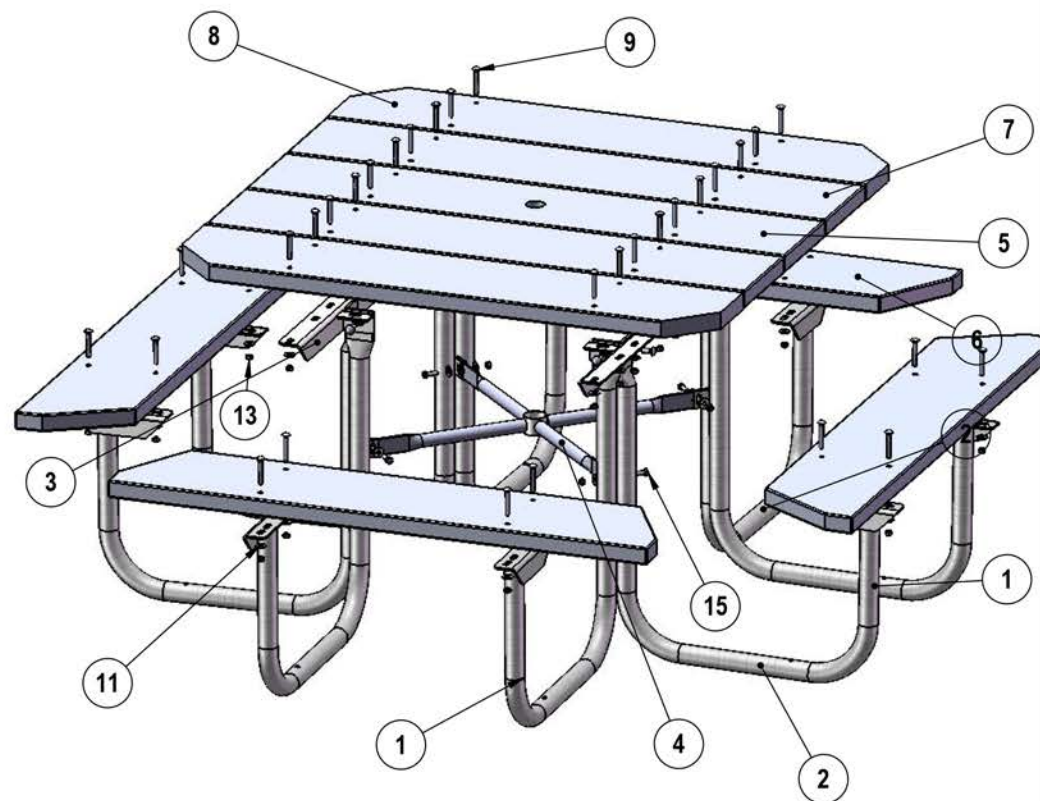

STEP 1

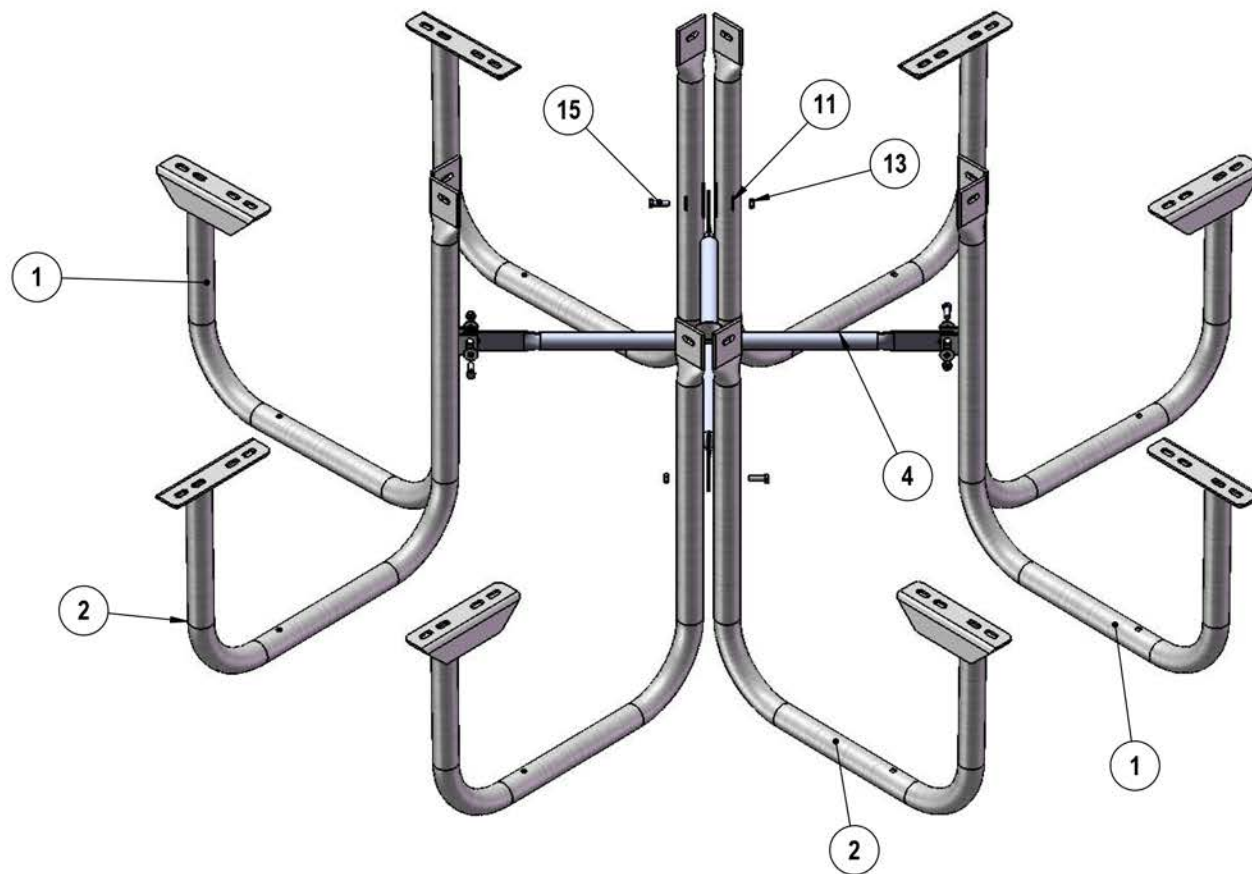

Attach the 398 legs to the 398 crossbrace using the specified hardware

STEP 2

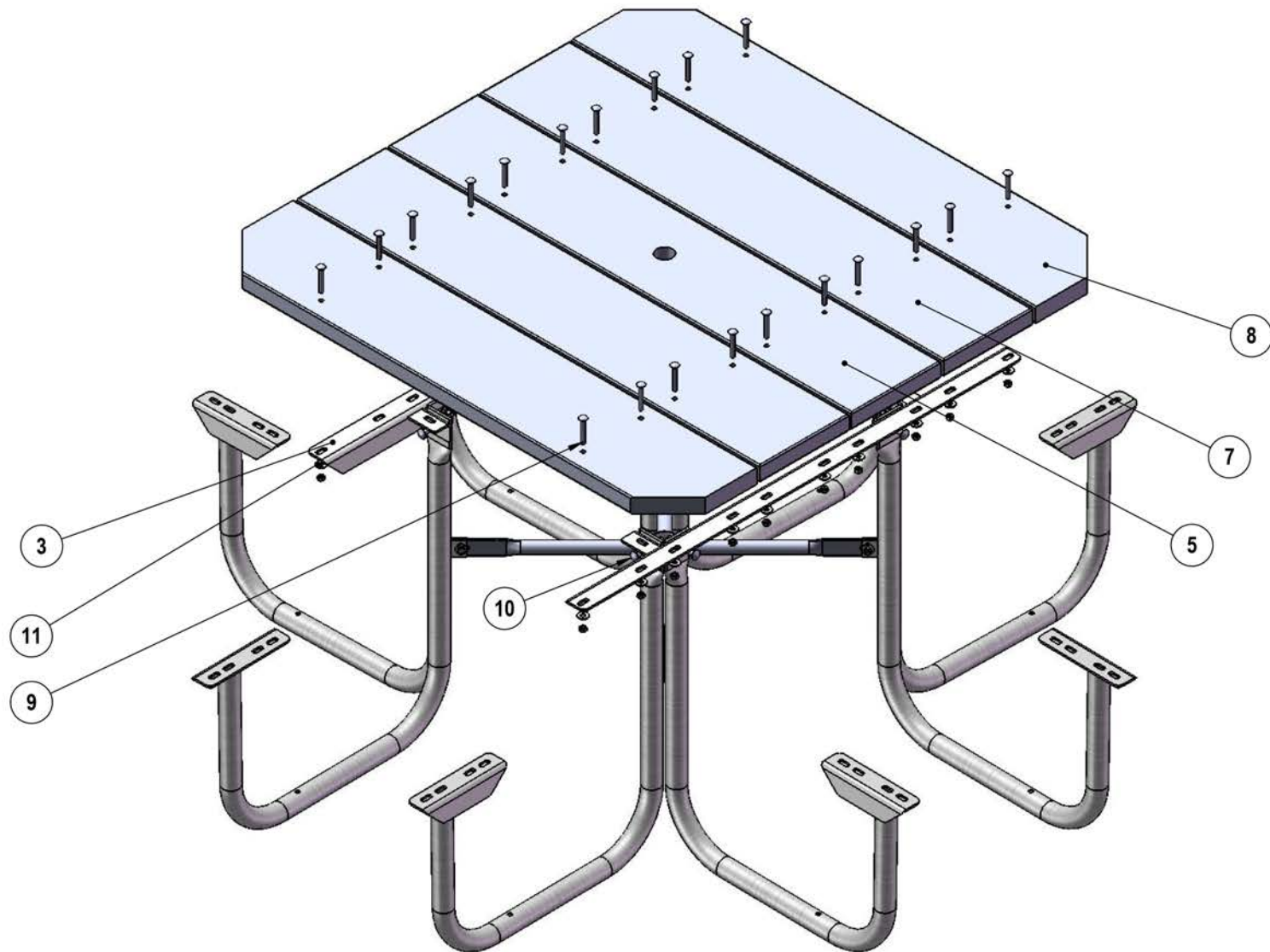

Attach the 398 angle assembly to the 398 legs with the specified hardware.
Then attach the 398 table planks to the 398 angle assembly with the specified hardware.

STEP 3

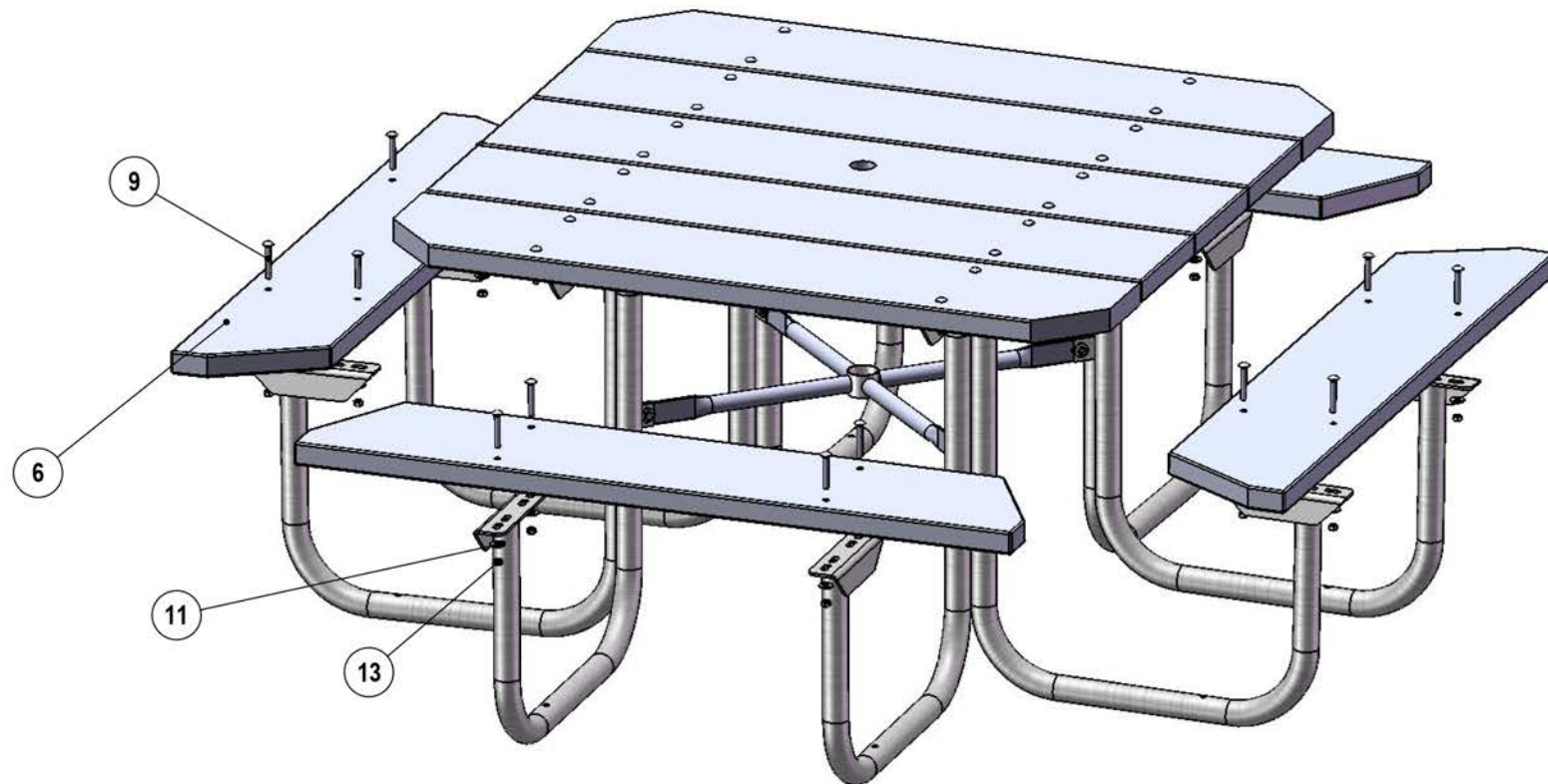

Attach the 48" Seat Planks to the 398 Legs using specified hardware.

OVERALL DIMENSIONS

