

# thepark

AND FACILITIES

C A T A L O G

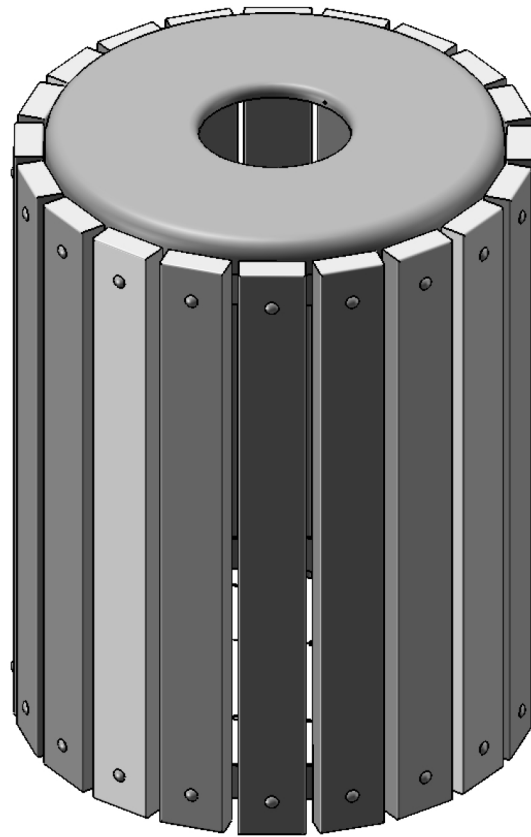

**32 Gallon Recycled Plastic Trash Receptacle**

Item #: 398-1468

## **SAFETY WARNINGS & EQUIPMENT INSPECTION**

- Owners and installers please note these safety warnings and make use of this checklist on a regular basis.
- Follow installation instructions when erecting equipment.
- Ground surfaces around equipment should be restored as needed. Concrete footings should never be exposed. Surface depth should comply with ASTM and CPSC specifications.
- Check for and repair damage caused by wear or vandalism, a major factor in injury causing situations.
- All protruding bolts should be covered or cut off and finished smooth. Sharp edges on pipes should be capped or removed. Check for bent, broken, or severely worn pipe, and replace.
- All equipment should be free of rust and repainted whenever necessary to deter rusting.
- We provide our customers with layout sheets and installation instructions. Please keep on file the specifications sheet that contains the listing of every part used.
- Never add components not intended for use with this product.
- Regular maintenance is necessary in this and all park and recreational equipment to insure the safety of the user.
- Note: Proper maintenance of equipment requires regular tightening of all bolts, nuts, and setscrews.
- Note: Regular checking of all parts, castings, etc. should be made. If a part is broken or worn, it should be replaced immediately.
- Check to be sure all fittings are tight and that bars and pipes do not move.
- Replace all worn S-hooks. S-hooks must be completely closed. Failure to close S-hooks can result in serious injury to the user. NEVER reuse S-hooks.
- Test for free movement of swing hanger and other moving attached parts.
- Check for worn chains and replace them.
- A soft resilient surface should be placed under all swings extending at least twice the height of the top rail both front and back.

## HARDWARE AND TOOLS REQUIRED REQUIRED

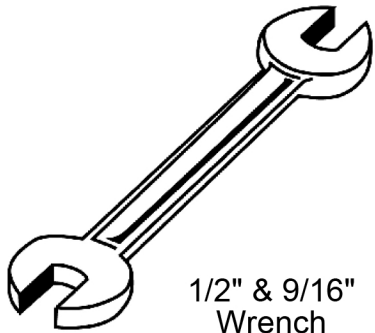

1/2" & 9/16"  
Wrench

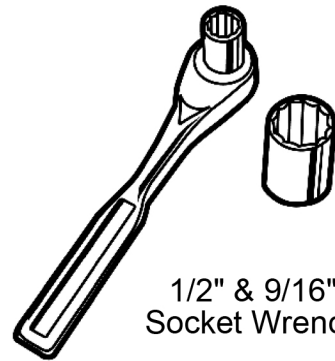

1/2" & 9/16"  
Socket Wrench

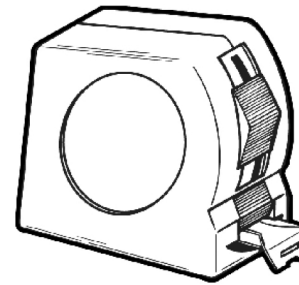

Tape Measure

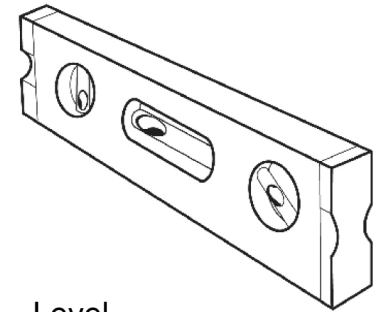

Level

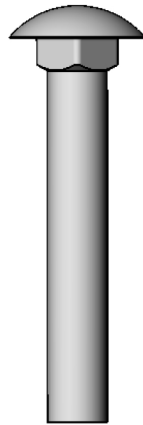

5/16" x 2"  
Carriage Bolt

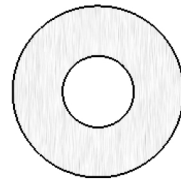

5/16" Washer

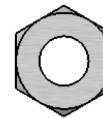

5/16" Hex Nut

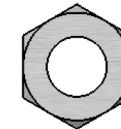

3/8" Hex Nut

# ULTRA SITE PRODUCT SPECIFICATIONS

## RECYLCED PLASTIC SLAT TRASH RECEPTACLE

Slats: Minimum of 96% commingled post-consumer or post-industrial recycled plastic 2x4. With a maximum of 4% due to various additives including color and UV stabilization to obtain desirable properties.

Frame: Rings are 3/16" x 2" flat. Bottom plate is precision punched from 12 ga. sheet steel. All electrically MIG welded.

Frame Coating: Hot dipped galvanized.

Hardware: All hardware fasteners are zinc coated.

Dimensions: 26" Diameter. Trash receptacle has an overall height of 34".

## 32 GALLON FLAT TOP

Material: Top plate shall be fabricated from 18 gauge steel flat, spun to form. Outside shall have a 1" radius.

Coating: Oven fused functionalized polyethylene copolymer-based thermoplastic. Fluidized bed coating application with superior mechanical performance, impact resistance and UV-stability.

Receptacle Dimensions: Center opening shall be an 8" inside diameter. The overall dimensions shall be 24" diameter x 2" high.

# COMPONENTS

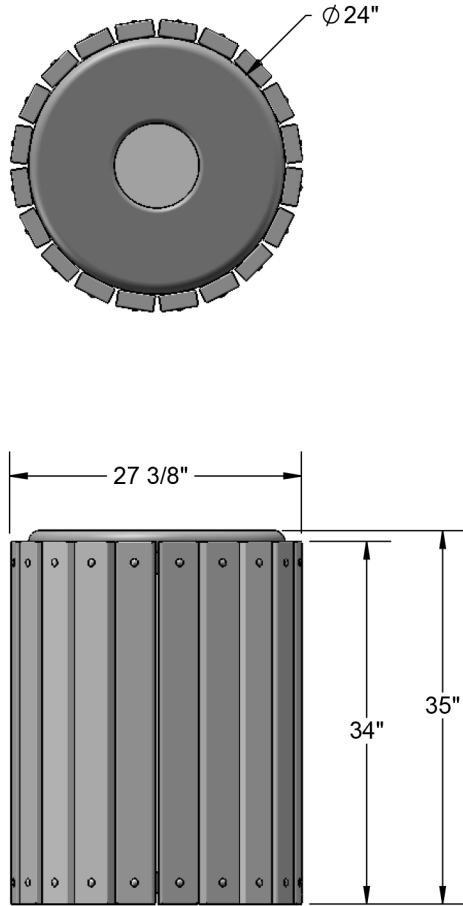

Attach the 34" Recycled planks to the TR-32 Ring and TR Bottom Ring assembly as shown using specified hardware. The 3/8" Nut between the Plank and the Rings are used as spacers to provide enough room for the top.

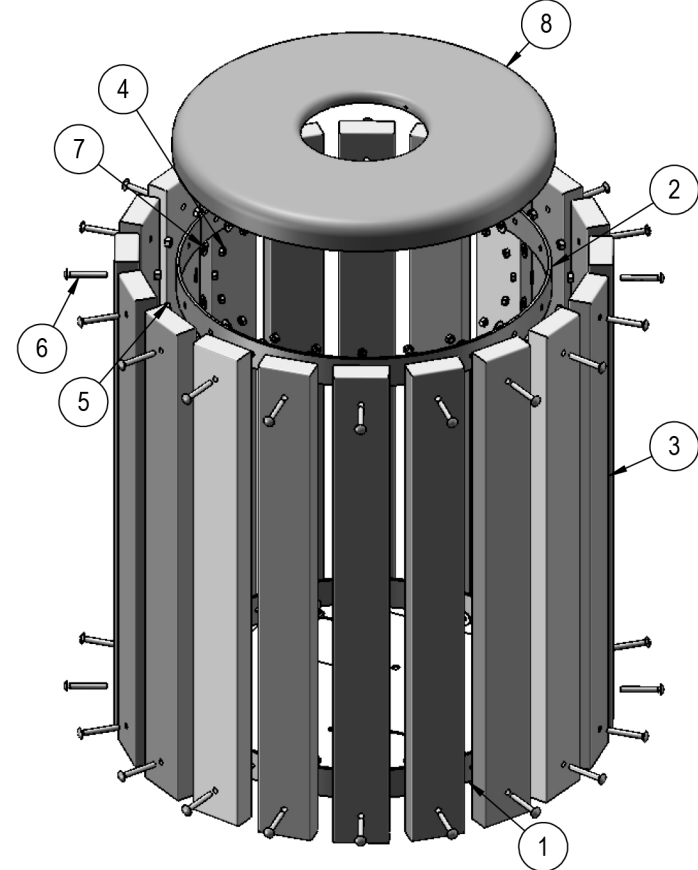

| ITEM NO. | PartNo  | DESCRIPTION  | QTY |
|----------|---|--|-----|
| 1        | 01-05-0054  | TR bottom ring assembly  | 1   |
| 2        | 01-05-0041  | TR-32 Ring   | 1   |
| 3        | BRN34-2x4-TR, CDR34-2x4-TR, GRN34-2x4-TR, or GRY34-2x4-TR | 2 x 4 Brown Recycled TR Plank (34"), 2 x 4 Cedar Recycled TR Plank (34"), 2 x 4 Green Recycled TR Plank (34"), or 2 x 4 Gray Recycled TR Plank (34") | 20  |
| 4        | 33-01-0001  | 5/16" Hex Nut (Zinc)   | 40  |
| 5        | 33-01-0002  | 3/8" Hex Nut (Zinc)  | 40  |
| 6        | 33-06-0019  | 5/16" x 2-1/2" Carriage Bolt (Zinc)  | 40  |
| 7        | 33-02-0001  | 5/16" Zinc Plated Washer   | 40  |
| 8        | FTR-32-08   | 32 Gallon Rolled Flat Top with a 8" opening  | 1   |

# INGROUND MOUNTING OPTION

## INGROUND MOUNT FOR TRASH RECEPTACLE

Frame: 2-3/8" O.D. x 12 gauge pre-galvanized structural steel tubing. Mounting points 3 gauge 8" x 8" steel flat bar. All electrically MIG welded.

Frame Coating: Electrostatic powder coated application oven cured.

Hardware: All stainless steel hardware fasteners. (Included).

Dimensions: Overall dimension is 24 1/4" x 8" x 8".

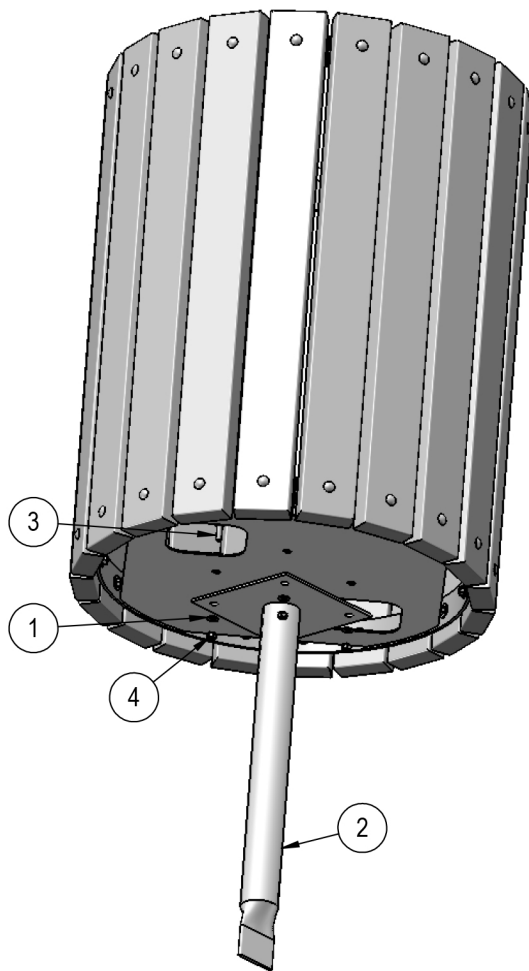

Attach the IG KIT as shown using specified hardware.

Estimated Required Concrete:  
5 - 50lb Bags of Concrete Mix

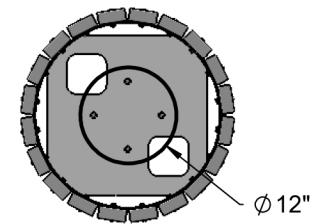
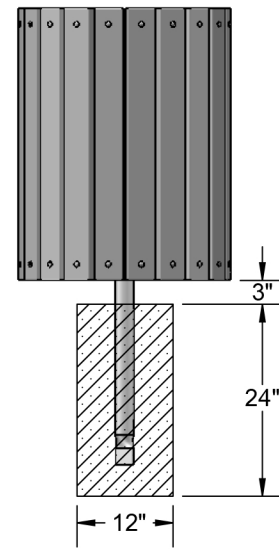

| ITEM NO. | PartNo       | DESCRIPTION                  | QTY |
|----------|--------------|------------------------------|-----|
| 1        | 33-02-0007   | 5/16" Flat Washer (SS)       | 8   |
| 2        | P-01-05-0052 | receptacle inground mount    | 1   |
| 3        | 33-05-0029   | 5/16" x 1" Machine Bolt (SS) | 4   |
| 4        | 33-03-0012   | 5/16" Kep Nut (SS)           | 4   |

# SURFACE MOUNT MOUNTING OPTION

## SURFACE MOUNT FOR TRASH RECEPTACLE

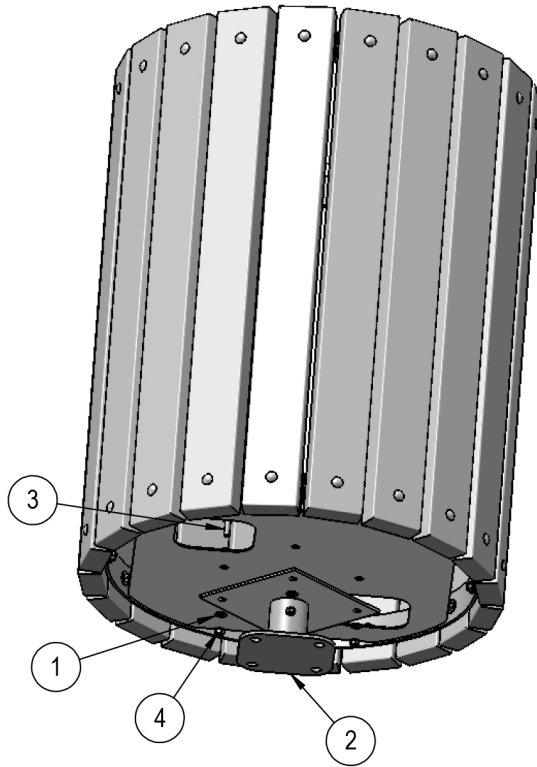

Frame: 2-3/8" O.D. x 12 gauge pre-galvanized structural steel tubing. Surface mounting points are 3 gauge 8" x 8" steel flat bar with four holes. Receptacle mounting points are 3 gauge 6" x 6" steel flat bar with 4 holes. All electrically MIG welded.

Frame Coating: Electrostatic powder coated application oven cured.

Hardware: All stainless steel hardware fasteners. (Included).

Dimensions: Overall dimension is 3-3/4" x 8" x 8".

Attach the SM KIT as shown using specified hardware.

Recommended Surface Mount Hardware:  
3/8" x 3-1/2" Concrete Expansion Anchor Bolts  
(Not Included)

| ITEM NO. | PartNo       | DESCRIPTION                  | QTY |
|----------|--------------|------------------------------|-----|
| 1        | 33-02-0007   | 5/16" Flat Washer (SS)       | 8   |
| 2        | P-01-05-0053 | receptacle surface mount     | 1   |
| 3        | 33-05-0029   | 5/16" x 1" Machine Bolt (SS) | 4   |
| 4        | 33-03-0012   | 5/16" Kep Nut (SS)           | 4   |

## LINER OPTION

32 Gallon Liner

Made of heavy duty plastic.

