

Material: 6061-T6 Aluminum.

Finish: Hard tumble to remove all machined and/or cut edges.
Type II Clear Anodize or Hard Anodize.

Anchoring: Two offset thru holes for Smart Pins Plus.
Use anchors in conjunction with two-part epoxy.

Product Spacing: 18" from end of planters/walls and approximately 36" centers.

thepark AND FACILITIES
CATALOG

Model No. 161-1003

for chamfer 3/4" or greater

SIZE A	DWG. NO.	REV.
SCALE	CAD FILE:	SHEET OF

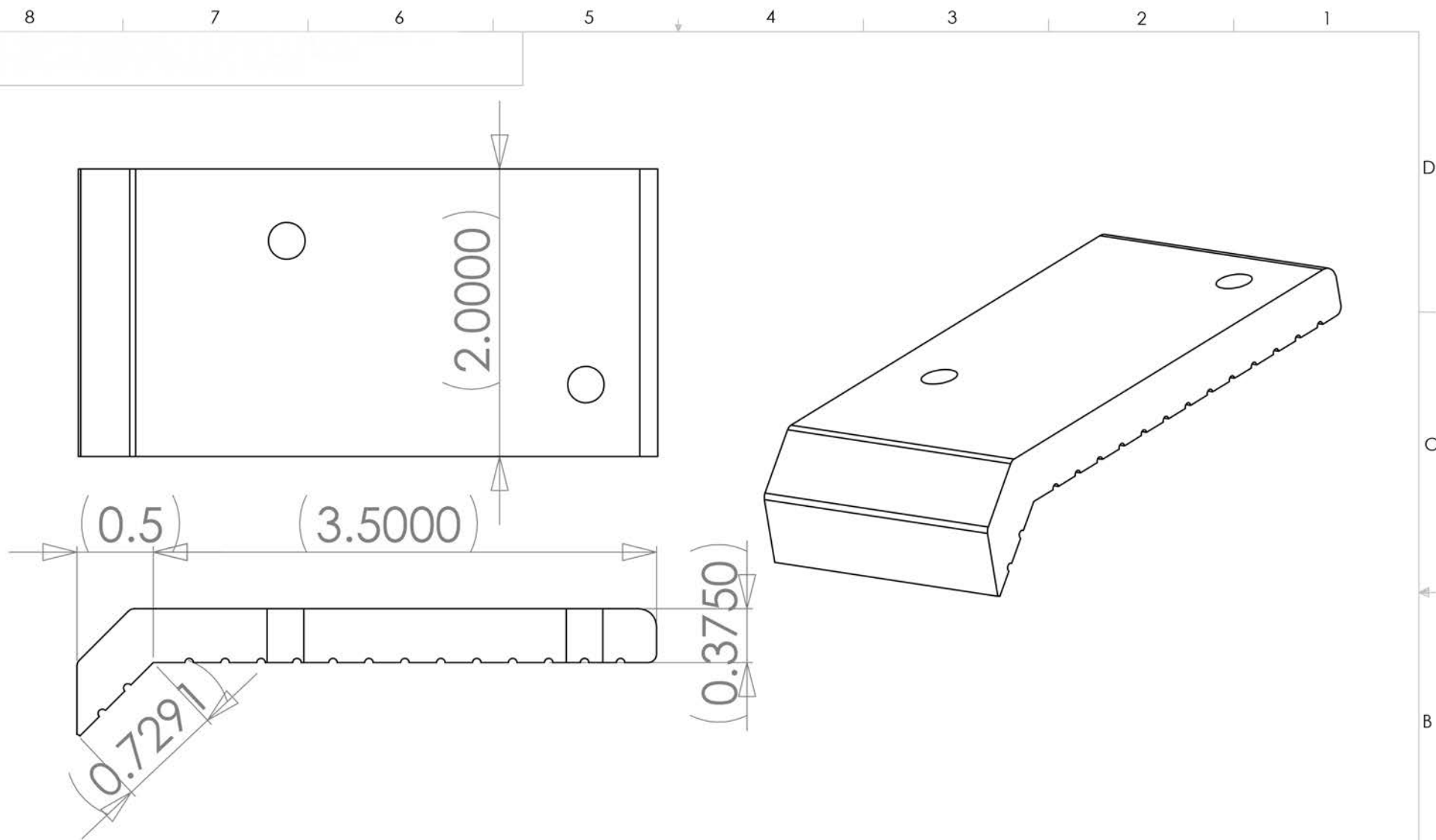

Material: 6061-T6 Aluminum.

Finish: Hard tumble to remove all machined and/or cut edges.
Type II Clear Anodize or Hard Anodize.

Anchoring: Two offset thru holes for Smart Pin Plus.
Use anchors in conjunction with two-part epoxy.

Product Spacing: 18" from end of planters/walls and approximately 36" centers.

thepark AND FACILITIES
CATALOG

Model No. 161-1003

Short

SIZE A	DWG. NO.	REV.
SCALE	CAD FILE:	SHEET OF
2	1	