

Product

46" Square 3 Seat Portable Accessible Table

Model: 543-6009

Materials:

3/4" #9 Expanded Metal or 1/2" Punched Steel
3/4" x 2" Angle Iron Outer Frame
1-1/2" x 1/4" Flat Steel Inside bracing
2" Round Tubing Frame Material
2" x 2" Angle Iron Frame Bracing
1" Round Tubing Cross Braces

Surface:

- ☐ Expanded
☐ Perforated

Finishes:

SealGuard

Polyethylene Thermoplastic applied by fluidized bed to maintain even and complete coating. UV stabilized, impact resistant, mold and mildew resistant, graffiti resistant.

Color Options:

Colors

Black | Burgundy | Burnt Red
Red | White | Ivory | Silver
Brown | Orange | Hunter Green

Mount Options:

- ☐ Portable

Top View

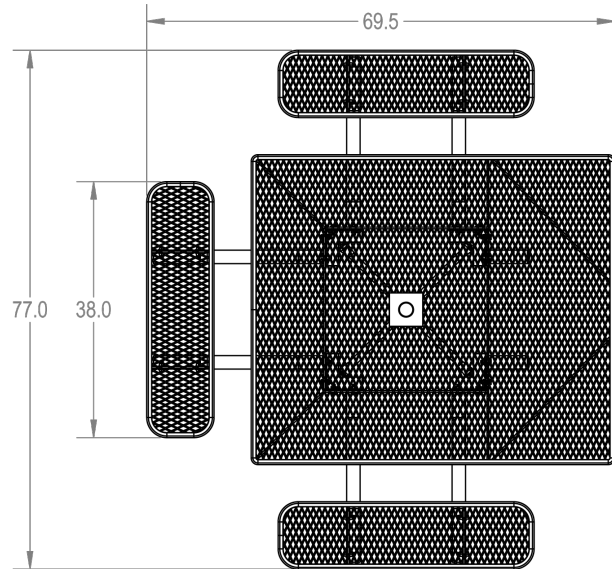

Front View

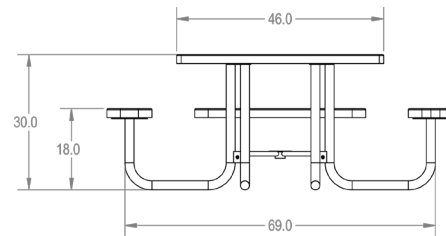

Side View

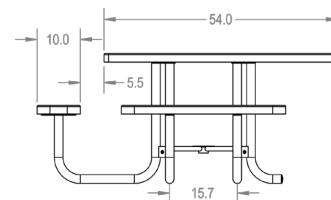

Punched
Hole

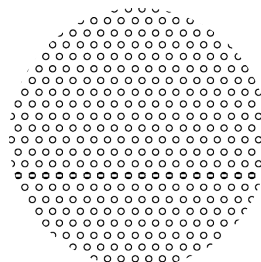

Expanded

