

**Recycled Plastic `Sport' Bench - 8 Ft.  
289-4009**

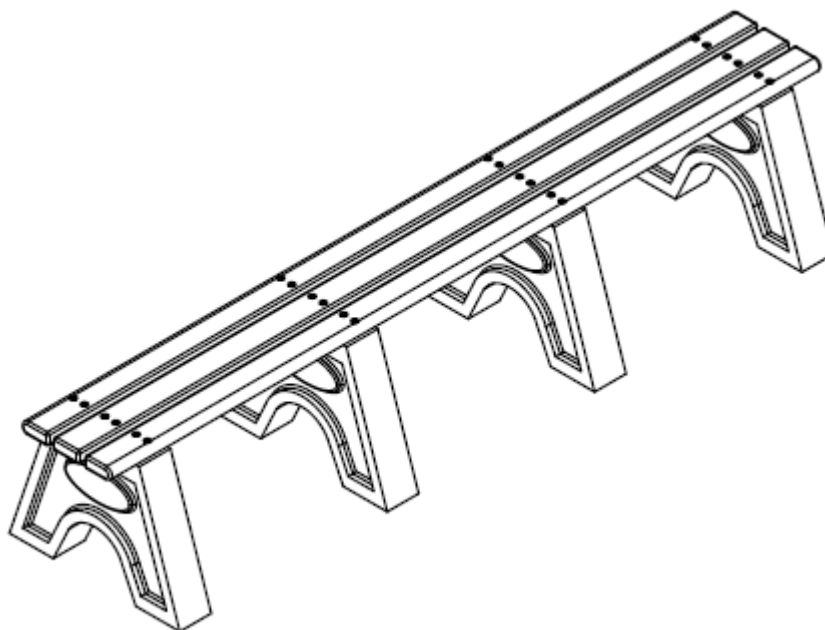

**Dimensions**

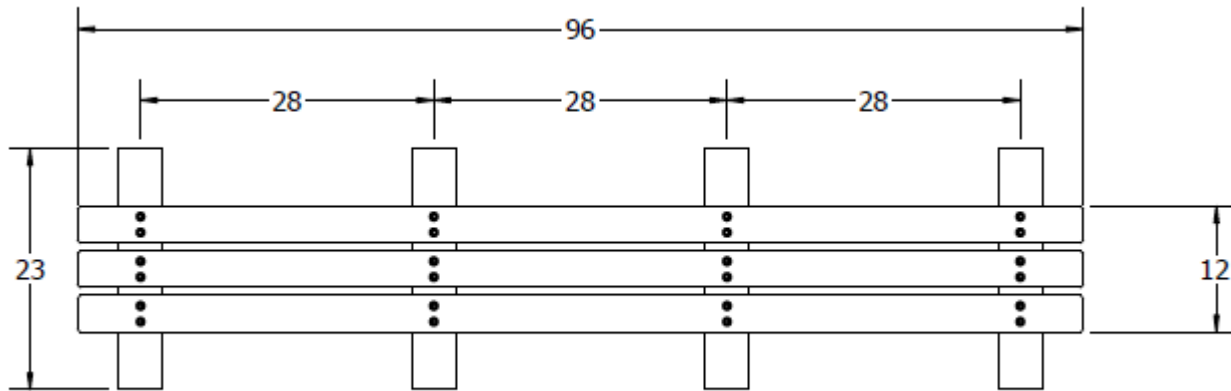

TOP VIEW

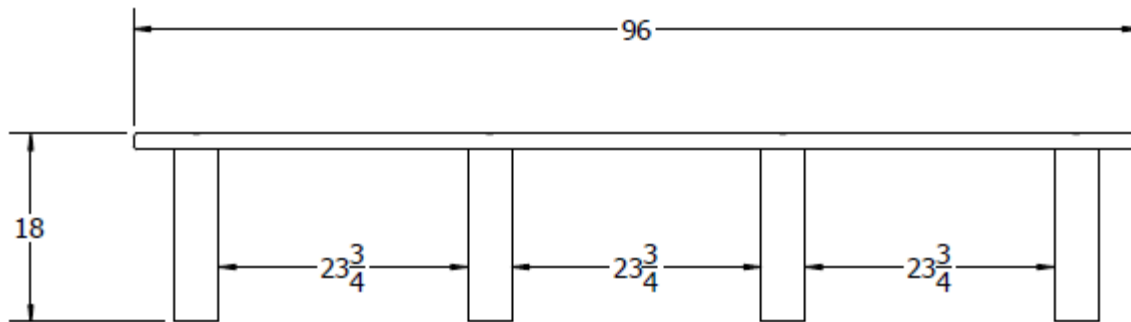

FRONT VIEW

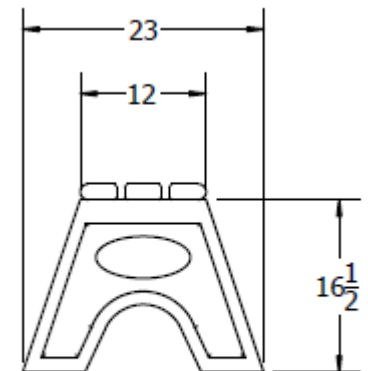

SIDE VIEW

**Components**

Tools for Assembly: Powered driver and 7/16 Socket  
Tape Measure

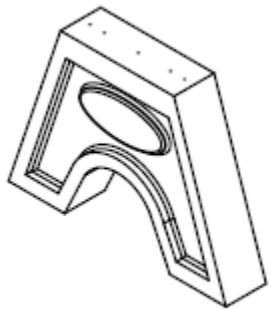

(4) Bases

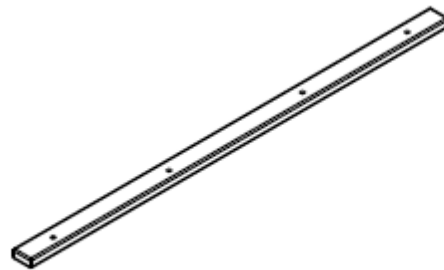

(1) Bench Slat

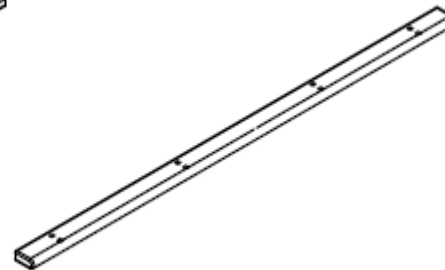

(2) Bullnose Bench Slat



(20) Hex Lag Screws &  
Flat Washers

**Assembly Instructions**

Before you begin: Check components to verify all are included. Assembly will require two people and must be performed on a level and smooth surface. Do not overtighten hardware as damage can occur.

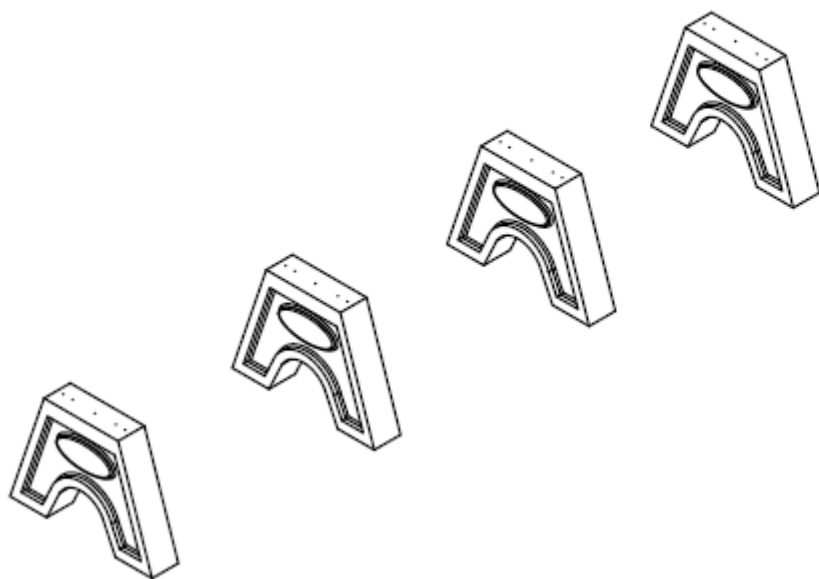

**Step 1**

Set the four bench bases in the upright position and parallel to each other approximately 2 feet apart.

**Assembly Instructions Cont.**

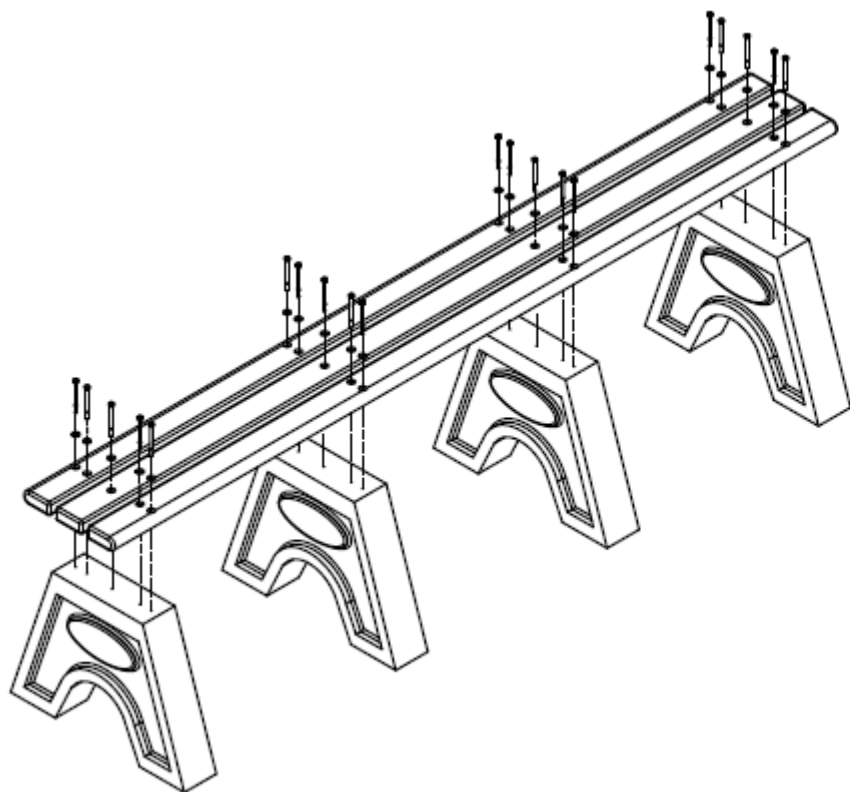

**Step 2**

Lay the two bullnose bench slats across the bases with one towards the front and the other to the back, the remaining bench slat will lie evenly spaced between the bullnose slats. Align the mounting holes in the slats with the pre-drilled holes in the bases. Attach using the hex head screws and flat washers, do not over-tighten.

**Cleaning Tips**

The Park Catalog products are durable and designed to last a lifetime, like most things that spend the majority of time outdoors, sometimes they need a little cleaning. In most cases, all a Park Catalog product requires is mild dish soap, a bucket of warm water and a clean cloth. Apply the soapy mixture to scrub away the dirt and then rinse with water. If you have some stubborn dirt down in the grooves and divots, mix 1 part bleach to 2 parts water, apply with your clean cloth, scrub with a soft bristle brush if needed and then rinse.